

MLS® #633809

0 Bedroom, 0.00 Bathroom,
Land on 6 Acres

Serene Lakefront Paradise Awaits! Nestled in the heart of picturesque Panama City, in the coveted Bay County area, lies a rare gem – Lot 39, a pristine unimproved parcel of land that spans an impressive 5.58 acres. This remarkable piece of nature's canvas boasts 346 feet of tranquil waterfront on the stunning Lake Powell, offering you the opportunity to create your dream oasis in one of Florida's most captivating settings.

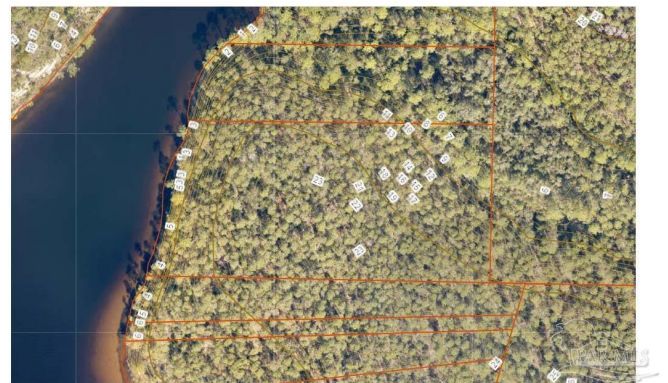

MLS® #	633809
Price	\$1,900,000
Bathrooms	0.00
Acres	5.58
Type	Land
Sub-Type	Land/Acreage
Status	Active

Address	Box Turtle Ln
Subdivision	None
City	Panama City Beach
County	Other Counties
State	FL
Zip Code	32413

Utilities Natural Gas Not Available, None



View	Lake
Is Waterfront	Yes
Waterfront	Lake, Waterfront, No Waterfront Features

Exterior

Lot Description	Wooded, No Improvements
-----------------	-------------------------

School Information

Elementary	Local School In County
Middle	Local School In County
High	Local School In County

Listing Details

Listing Office	CENTURY 21 J. Carter & Company
----------------	--------------------------------

Copyright© 2024 by the Multiple Listing Service of the Pensacola Association of REALTORS®. This information is believed to be accurate but is not guaranteed. Subject to verification by all parties. This data is copyrighted and may not be transmitted, retransmitted, copied, framed, repurposed, or altered in any way for any other site, individual and/or purpose without the express written permission of the Multiple Listing Service of the Pensacola Association of REALTORS®. Florida recognizes single and transaction agency relationships. Information Deemed Reliable But Not Guaranteed. Any use of search facilities of data on this site, other than by a consumer looking to purchase real estate, is prohibited.