

\$120,000 - Parcel A Santee St, CRESTVIEW

MLS® #942820

\$120,000

Bedroom, Bathroom, 435,600 sqft
Land on 10 Acres

METES & BOUNDS, CRESTVIEW, FL

LOCATION, LOCATION, LOCATION! Check out this 10 acre parcel convenient to town! Per the owner, the parcel has a stream running through it. Bring your house plans and watch your dreams become reality. Sale is contingent upon a lot split with Okaloosa County. 10 adjacent acres listed under MLS 942821.

Essential Information

MLS® #	942820
Price	\$120,000
Square Footage	435,600
Acres	10.00
Type	Land
Sub-Type	Residential Land
Status	Active

Community Information

Address	Parcel A Santee St
Area	Crestview Area
Subdivision	METES & BOUNDS
City	CRESTVIEW
County	OKALOOSA
State	FL
Zip Code	32539

Amenities

Utilities	NONE
-----------	------

School Information

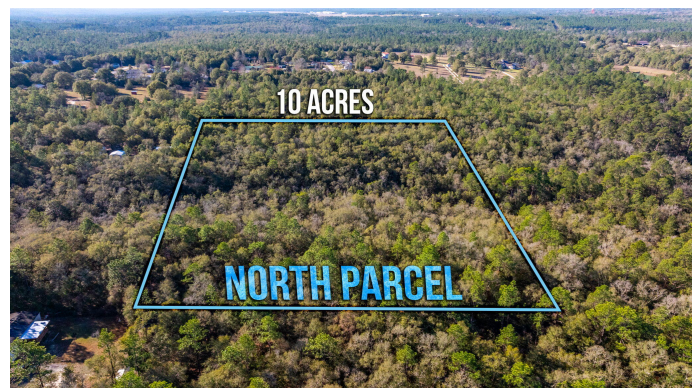
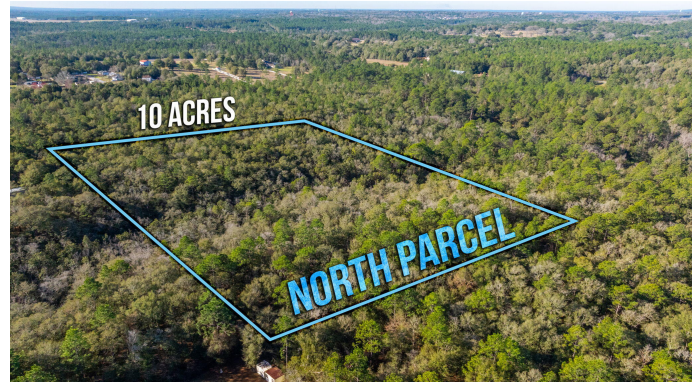

Elementary	BOB SIKES
Middle	DAVIDSON
High	CRESTVIEW

Additional Information

Days on Website	88
Zoning	Residential Single Family
HOA Fees	0.00

Listing Details

Listing Office	ERA American Real Estate
----------------	--------------------------

DISCLAIMER: Information Deemed Reliable but not guaranteed. The information being provided is for consumers' personal, non-commercial use and may not be used for any purpose other than to identify prospective properties consumers may be interested in purchasing.All listings are provided courtesy of the Emerald Coast Association of Realtors, Copyright2024, All rights reserved.