

\$619,500 - 209 Abner Way Lot 24, NICEVILLE

MLS® #933246

\$619,500

4 Bedroom, 3.00 Bathroom, 2,350 sqft
Residential on 0 Acres

EAGLES LANDING S/D, NICEVILLE, FL

EAGLES LANDING New Construction in the heart of Niceville! BUILDER OFFERING SPECIAL INCENTIVES! Come visit the model to learn more about Eagles Landing. These homes feature gorgeous interiors to include: 8' doors, LVP and tile flooring, quartz counter tops, soft close cabinetry & drawers, Bosch stainless steel appliances (frig, microwave, dual fuel convection range & dishwasher), tankless gas hot water heater, tiled showers, impact windows & doors, smart panel for your tech, finished garage, screened porch, patio & much more! Full landscaping & irrigation included. Several models and lots to select from, come build your dream home. Model open 10-2 pm Mon-Fri. & by appointment. Call/text for more information! Buyer to verify all deemed important information.

Built in 2024

Essential Information

MLS® #	933246
Price	\$619,500
Bedrooms	4
Bathrooms	3.00
Full Baths	3
Square Footage	2,350
Acres	0.17
Year Built	2024
Type	Residential



1 FRONT ELEVATION
SCALE: 1/4" = 1'-0"

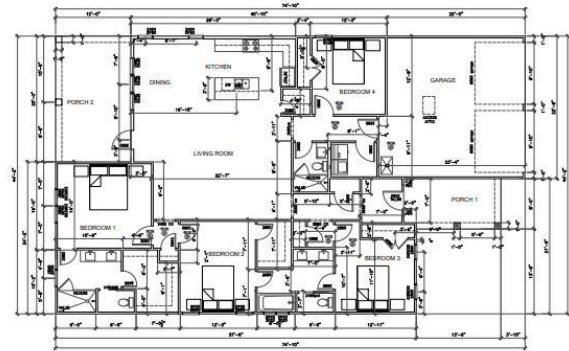

1 FLOOR PLAN
SCALE: 1/8" = 1'-0"



Sub-Type	Detached Single Family
Style	Craftsman Style
Status	Active

Community Information

Address	209 Abner Way Lot 24
Area	Niceville
Subdivision	EAGLES LANDING S/D
City	NICEVILLE
County	OKALOOSA
State	FL
Zip Code	32578

Amenities

Utilities	Gas - Natural, Public Sewer Available, Public Water Available, Underground
Parking Spaces	2
Parking	Garage: Attached
# of Garages	2

Interior

Interior Features	Breakfast Bar, Ceiling Crwn Molding, Floor Tile, Floor Vinyl, Kitchen Island, Lighting Recessed, Newly Painted, Pantry, Pull Down Stairs, Split Bedroom, Washer/Dryer Hookup, Woodwork Painted
Appliances	Auto Garage Door Opn, Dishwasher, Disposal, Microwave, Oven:Self Cleaning, Refrigerator W/Ice Maker, Stove/Oven Dual Fuel
Heating	Heat: Central Electric, Heat High Efficiency
Cooling	A/C: Central Electric, A/C: High Efficiency, Ceiling Fans
# of Stories	1

Exterior

Exterior	Siding Brick All, Frame, Roof Dimensional Shingle, Siding CmntFbrHrdBrd, Trim Vinyl
Exterior Features	Fenced Lot-Part, Patio Open, Porch Screened, Rain Gutter, Sprinkler System
Lot Description	Covenants, Curb & Gutter, Easements, Level, Restrictions
Windows	Double Paned Windows
Roof	Roof Dimensional Shingle
Construction	Frame

School Information

Elementary	EDGE
------------	------

Middle	Ruckel
High	NICEVILLE

Additional Information

Days on Website	234
Zoning	Residential Single Family
HOA Fees	200.00
HOA Fees Freq.	Annually

Listing Details

Listing Office	Eagle Bay Real Estate
----------------	-----------------------

DISCLAIMER: Information Deemed Reliable but not guaranteed. The information being provided is for consumers' personal, non-commercial use and may not be used for any purpose other than to identify prospective properties consumers may be interested in purchasing.All listings are provided courtesy of the Emerald Coast Association of Realtors, Copyright2024, All rights reserved.