

NINTH LEVEL

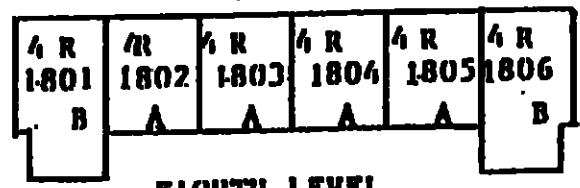

EIGHTH LEVEL

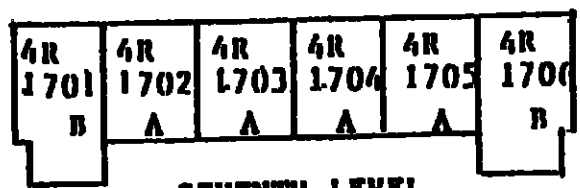

SEVENTH LEVEL

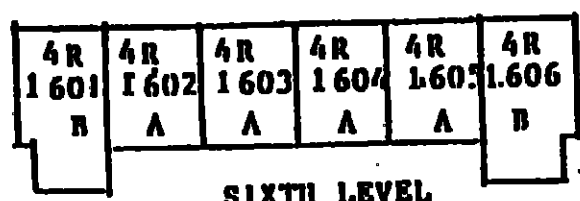

SIXTH LEVEL

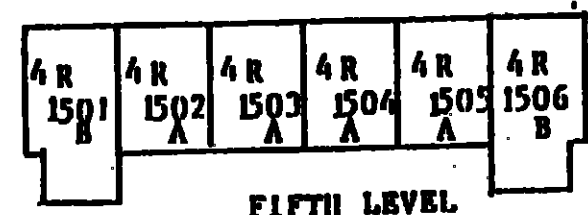

FIFTH LEVEL

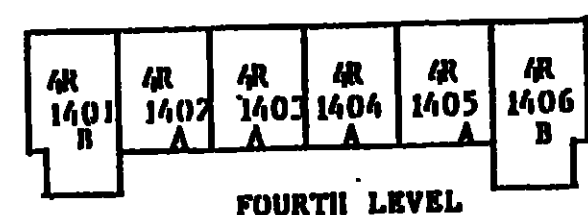

FOURTH LEVEL

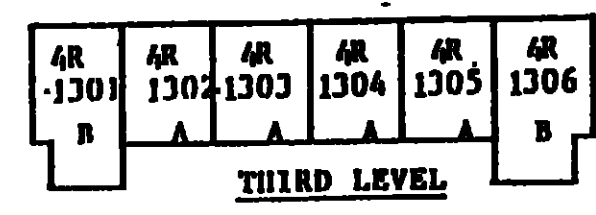

THIRD LEVEL

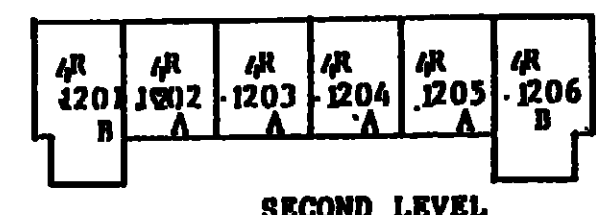

SECOND LEVEL

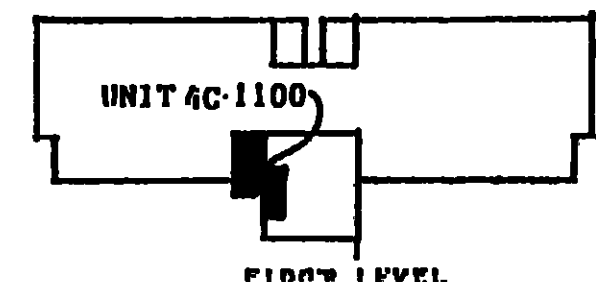

FIRST LEVEL

ALL OF THE REAL PROPERTY DESCRIBED ON THE PLANS IS SUBJECT TO DEVELOPMENT RIGHTS AS SET OUT IN THE DECLARATION OF CONDOMINIUM OF OCEAN HOUSE, A CONDOMINIUM. THE DEVELOPER RESERVES THE RIGHT TO:
 (1) ADD REAL ESTATE TO THE CONDOMINIUM;
 (2) CREATE BRITS, COMMON ELEMENTS, OR LIMITED COMMON ELEMENTS;
 (3) BRIDGE BRITS, OR CONVERT UNITS TO COMMON ELEMENTS.

UNIT LOCATION PLANS BY LEVEL
 OCEAN HOUSE, A CONDOMINIUM
 PHASE I

R- Residential Unit
 C- Commercial Unit