

APP. BK 22 PG 57

NOTE
 ALL RESIDENTIAL UNIT BALCONIES ARE TO BE LIMITED COMMON ELEMENT.
 ALL RESIDENTIAL UNITS ARE TO BE PRIVATE ELEMENT.
 ALL OTHER AREAS TO BE COMMON ELEMENTS UNLESS OTHERWISE NOTED.

THE UNDERSIGNED, HENRY MORRIS, A REGISTERED ARCHITECT IN THE STATE OF ALABAMA, REGISTRATION NUMBER 2685, PURSUANT TO SECTION 16-1-10, REGISTRATION NUMBER 928, HEREBY CERTIFY THAT TO THE BEST OF HIS KNOWLEDGE, DRAWINGS CONSISTING OF PAGES 1 THROUGH 32 INCLUSIVE, ATTACHED TO AND MADE PART OF THE DECLARATION OF CONDOMINIUM OF CARIBE RESORT, A CONDOMINIUM, CONTAINS ALL INFORMATION REQUIRED BY SAID SECTION, FULLY AND ACCURATELY DEPICT THE LAYOUT, LOCATIONS, UNIT NUMBERS AND APPROXIMATE DIMENSIONS IN SUFFICIENT DETAIL TO IDENTIFY THE COMMON ELEMENTS, LIMITED COMMON ELEMENTS AND PRIVATE ELEMENTS COMPRISING SUCH UNITS OF CARIBE RESORT CONDOMINIUM, AS BUILT.

Henry Morris
 ALABAMA REGISTRATION NUMBER 2685
 DATE 4/1/02

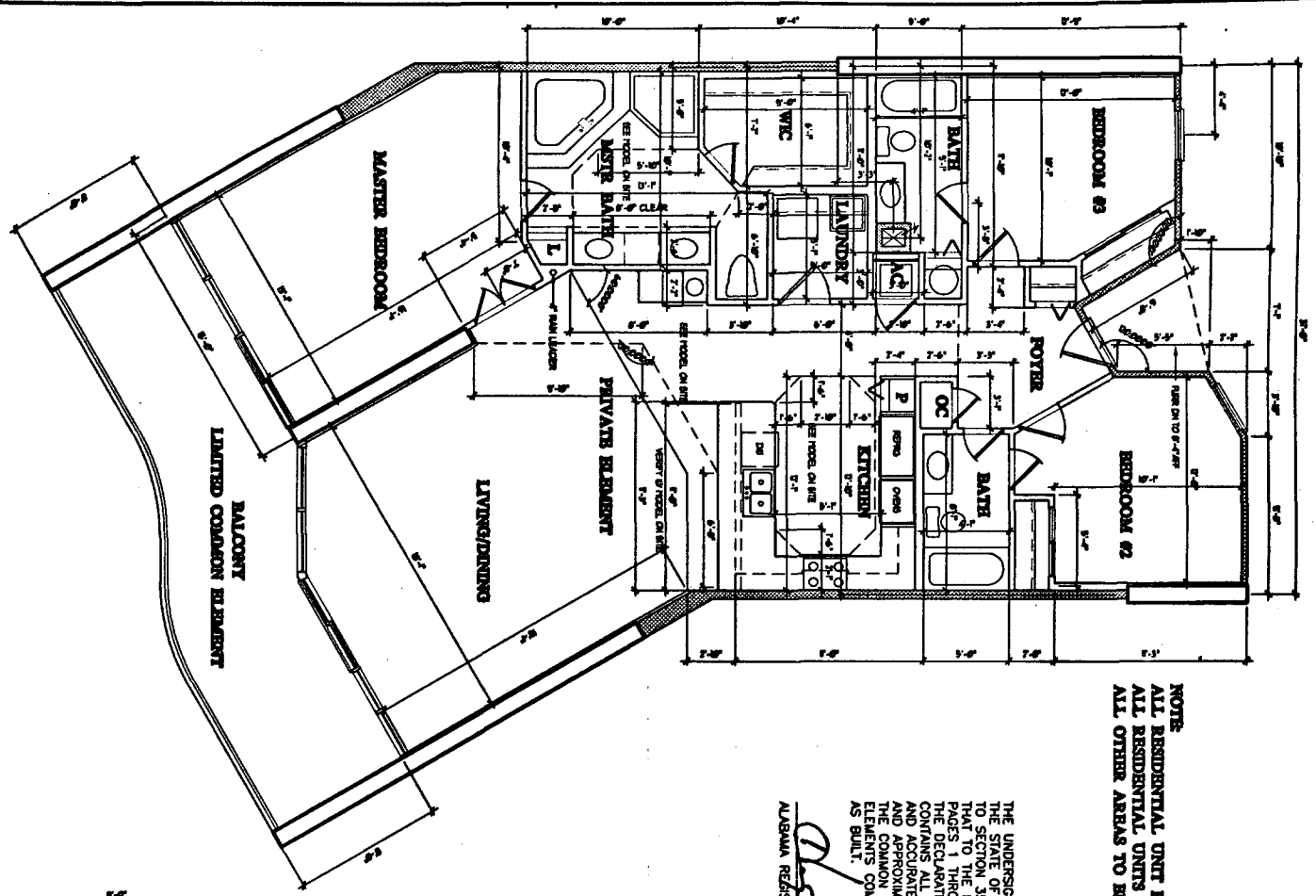

TYPICAL FLOOR PLAN UNIT B

1764' HEAVYWOOD,
 2304' BALCONY
 2964' TOTAL

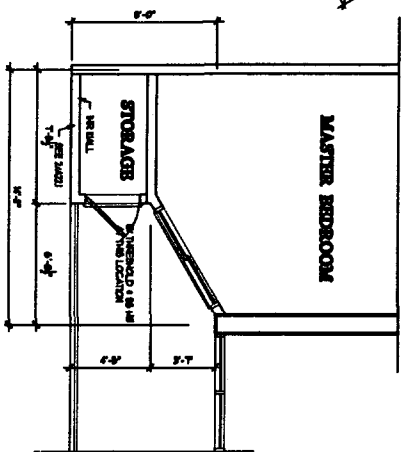

MODIFICATIONS @ A'

1834' HEAVYWOOD,
 2284' BALCONY/TORSE
 2094' TOTAL

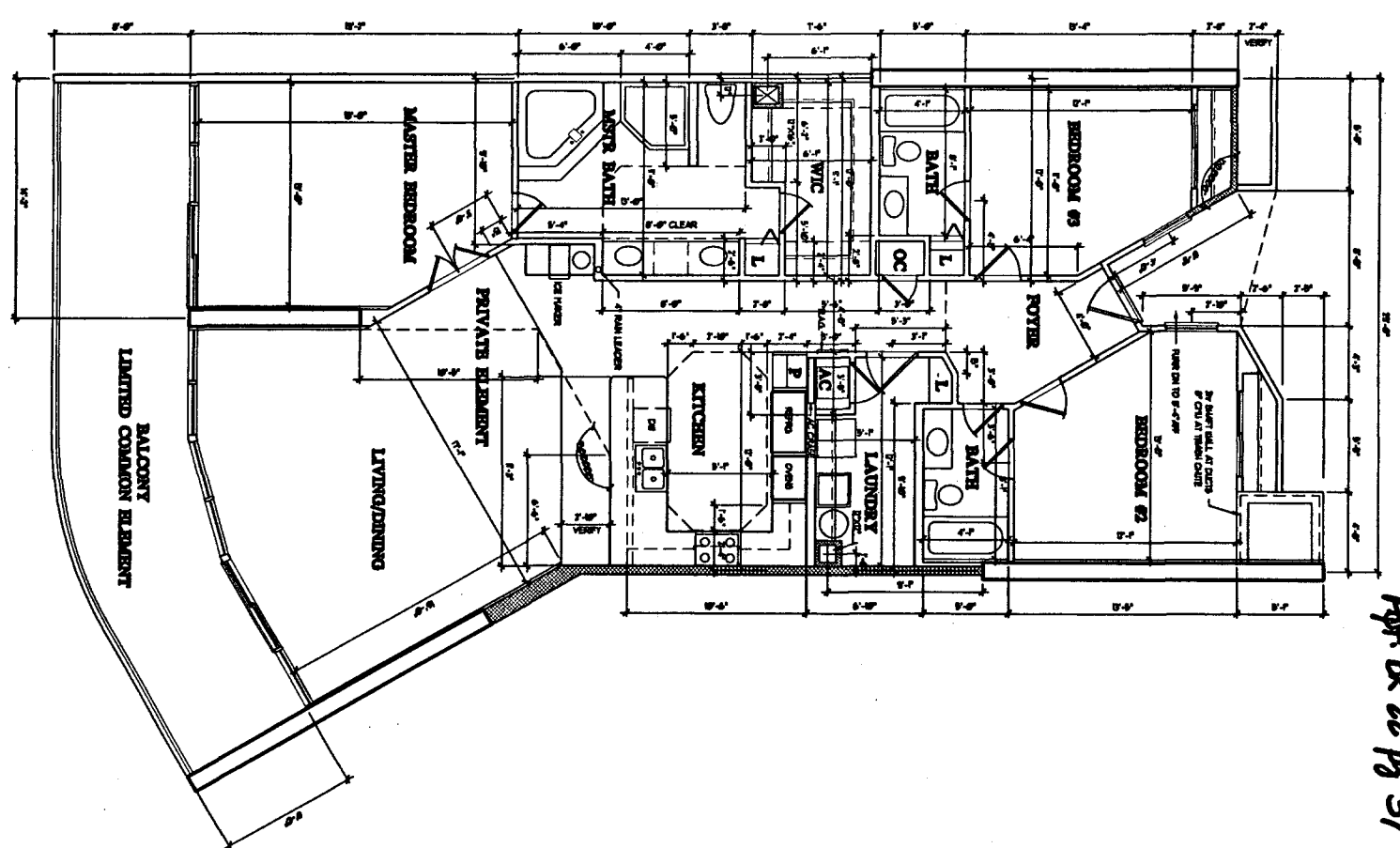

TYPICAL FLOOR PLAN UNIT A

1744' HEAVYWOOD,
 2714' BALCONY
 2094' TOTAL

Interlocked G-1175 Reg. Bldg. 23



HENRY MORRIS & ASSOC., INC.
 ARCHITECTURE & ENVIRONMENTAL DESIGN
 30 N. PALMWAY
 FLORENCE, ALABAMA 36688
 (205) 453-0301
 FAX (205) 453-0301
 hmo@hmoarch.com

CARIBE RESORT
 ORANGE BEACH, ALABAMA

JOB NO. 090807
 DR. 100L
 ORDER 144
 DATE 4/6/02
 REVISIONS

UNTS A.1.B
 SHEET
27
 OF 32

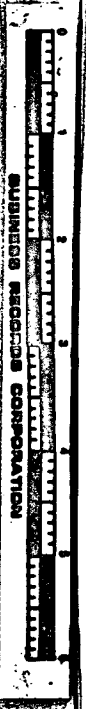

© HENRY MORRIS & ASSOCIATES, INC.