

APR 22 1993



HENRY MORRIS & ASSOC. INC.  
ARCHITECTURE & ENVIRONMENTAL DESIGN

20 N. PALMBOX  
PENSACOLA  
FLORIDA 32501

(904) 433-4011  
FAX 433-9011  
henry@hmoa.com

# CARIBE RESORT

ORANGE BEACH, ALABAMA

200 NO. GRENWICH  
OR. FOLK  
CHECKED 1/4/93  
DATE 4/4/93  
REVISIONS

FLOOR PLAN L1LV-2  
SHEET  
3  
OF 30

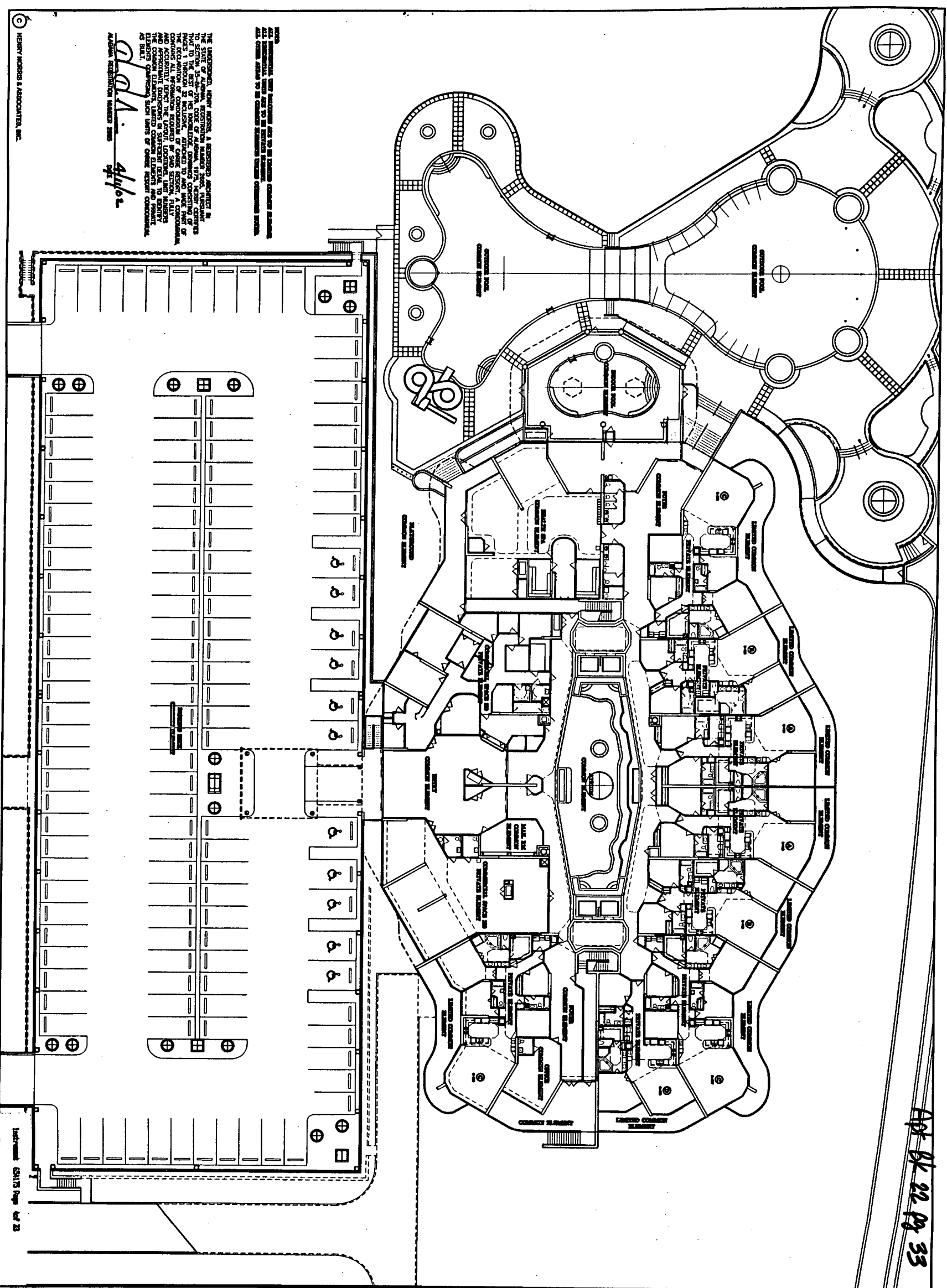

NOTES:  
1. ALL DIMENSIONS ARE TO FACE UNLESS OTHERWISE NOTED.  
2. ALL DIMENSIONS ARE TO BE CHECKED BEFORE CONSTRUCTION.  
3. ALL DIMENSIONS ARE TO BE CHECKED BEFORE CONSTRUCTION.

THE UNDERSIGNED, HENRY MORRIS & ASSOCIATES, INC., ARCHITECTS, REGISTERED PROFESSIONAL ARCHITECTS IN THE STATE OF ALABAMA, REGISTERED NUMBER 2880, HEREBY CERTIFY THAT THIS FLOOR PLAN IS A TRUE AND CORRECT REPRESENTATION OF THE DESIGN AND CONSTRUCTION OF THE CARIBE RESORT, A CONDOMINIUM PROJECT, AS SHOWN ON THESE PLANS, AND THAT THE DESIGN AND CONSTRUCTION OF THE CARIBE RESORT, A CONDOMINIUM PROJECT, IS IN ACCORDANCE WITH THE ALABAMA CONDOMINIUM ACT AND ALL APPLICABLE LAWS, ORDINANCES, AND REGULATIONS. THE UNDERSIGNED, HENRY MORRIS & ASSOCIATES, INC., ARCHITECTS, REGISTERED PROFESSIONAL ARCHITECTS IN THE STATE OF ALABAMA, REGISTERED NUMBER 2880, HEREBY CERTIFY THAT THIS FLOOR PLAN IS A TRUE AND CORRECT REPRESENTATION OF THE DESIGN AND CONSTRUCTION OF THE CARIBE RESORT, A CONDOMINIUM PROJECT, AS SHOWN ON THESE PLANS, AND THAT THE DESIGN AND CONSTRUCTION OF THE CARIBE RESORT, A CONDOMINIUM PROJECT, IS IN ACCORDANCE WITH THE ALABAMA CONDOMINIUM ACT AND ALL APPLICABLE LAWS, ORDINANCES, AND REGULATIONS.

HENRY MORRIS & ASSOCIATES, INC.

PROPERTY OF HENRY MORRIS & ASSOCIATES, INC.  
SUBJECT TO RECORDING BY HENRY MORRIS & ASSOCIATES, INC.