

Apr. 05 22 19 45

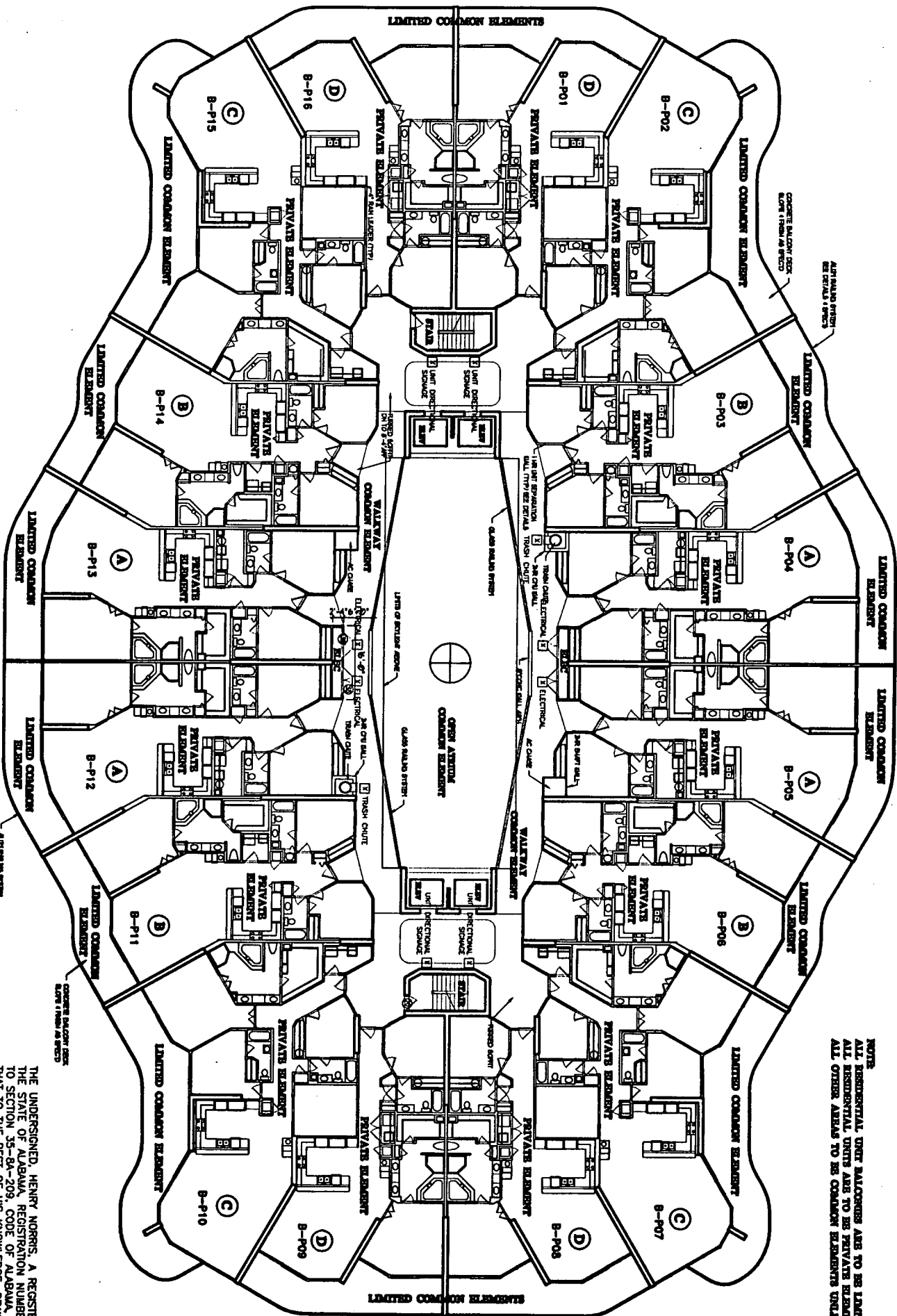

TYPICAL FLOOR PLAN LEVEL 14

THE UNDERSIGNED, HENRY NORRIS, A REGISTERED ARCHITECT IN THE STATE OF ALABAMA, REGISTRATION NUMBER 2665, PURSUANT TO SECTION 35-8A-209, CODE OF ALABAMA, 1975, HEREBY CERTIFIES THAT TO THE BEST OF HIS KNOWLEDGE, DRAWINGS CONSISTING OF PAGES 1 THROUGH 32 INCLUSIVE, ATTACHED TO AND MADE PART OF THE DECLARATION OF CONDOMINIUM OF CARIBE RESORT, FULLY CONTAINS ALL INFORMATION REQUIRED BY SAID SECTION, FULLY AND ACCURATELY DEPICT THE LAYOUT, LOCATIONS, UNIT NUMBERS AND APPROXIMATE DIMENSIONS IN SUFFICIENT DETAIL TO IDENTIFY THE COMMON ELEMENTS, LIMITED COMMON ELEMENTS AND PRIVATE ELEMENTS COMPRISING SUCH UNITS OF CARIBE RESORT CONDOMINIUM, AS BUILT.

ALABAMA REGISTRATION NUMBER 2665

Scale: 1/8" = 1'-0"

NOTE:
ALL RESIDENTIAL UNIT BALCONIES ARE TO BE LIMITED COMMON ELEMENT.
ALL RESIDENTIAL UNITS ARE TO BE PRIVATE ELEMENT.
ALL OTHER AREAS TO BE COMMON ELEMENTS UNLESS OTHERWISE NOTED.



HENRY NORRIS & ASSOC., INC.
ARCHITECTURE & ENVIRONMENTAL DESIGN

301 N. PALMER
TALLAHASSEE, FLORIDA 32301
(904) 433-4311
FAX (904) 433-4311
henry@hna.com

CARIBE RESORT
ORANGE BEACH, ALABAMA

AS BUILT: 09/08/07
DATE: 04/04/07
DRAWN: 4/4/07
CHECKED: 4/4/07
DESIGNED: 4/4/07

TYP FLOOR PLAN SHEET

15 OF 30