

Apr BK 22 pg 42

NOTE
 ALL RESIDENTIAL UNIT BALCONIES ARE TO BE LIMITED COMMON ELEMENT.
 ALL RESIDENTIAL UNITS ARE TO BE PRIVATE ELEMENT.
 ALL OTHER AREAS TO BE COMMON ELEMENTS UNLESS OTHERWISE NOTED.

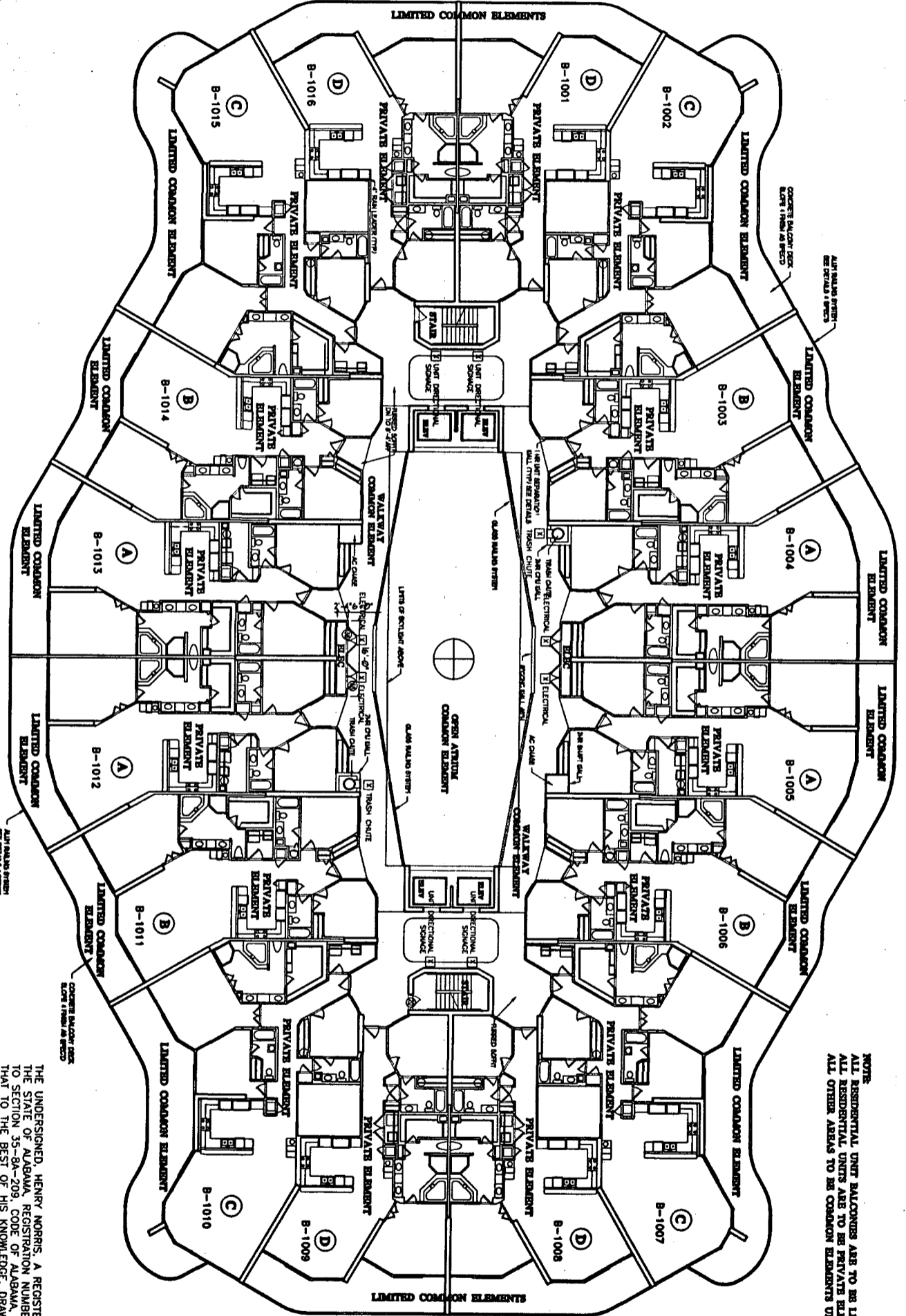

TYPICAL FLOOR PLAN LEVEL II

THE UNDERSIGNED, HENRY NORRIS, A REGISTERED ARCHITECT IN THE STATE OF ALABAMA, REGISTRATION NUMBER 2665, PURSUANT TO SECTION 35-8A-209, CODE OF ALABAMA, 1975, HEREBY CERTIFIES THAT TO THE BEST OF HIS KNOWLEDGE, DRAWINGS CONSISTING OF PAGES 1 THROUGH 32 INCLUSIVE, ATTACHED TO AND MADE PART OF THE DECLARATION OF CONDOMINIUM OF CARIBE RESORT, A FULLY CONTAINING ALL INFORMATION REQUIRED BY SAID SECTION, FULLY AND ACCURATELY DEPICT THE LAYOUT, LOCATIONS, UNIT NUMBERS AND APPROXIMATE DIMENSIONS IN SUFFICIENT DETAIL TO IDENTIFY THE COMMON ELEMENTS, LIMITED COMMON ELEMENTS AND PRIVATE ELEMENTS COMPRISING SUCH UNITS OF CARIBE RESORT CONDOMINIUM, AS BUILT.

Henry Norris
 ALABAMA REGISTRATION NUMBER 2665
 DATE 4/1/02

Architectural SALES Page 13 of 23

© HENRY NORRIS & ASSOCIATES, INC.

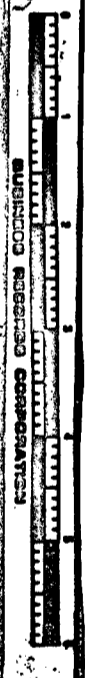

HN

HENRY NORRIS & ASSOC., INC.
 ARCHITECTS & ENVIRONMENTAL DESIGNERS

30 N. PALM FOX
 PENSACOLA, FLORIDA 32501
 (904) 433-6011
 FAX 433-5011
 henry@hna.com

CARIBE RESORT
 ORANGE BEACH, ALABAMA

23 NO. 07/04/01
 CD. 1/04
 ORDER 144
 DATE 4/1/02
 REVISIONS

TYP FLOOR PLAN
 SHEET
12

OF 23