

App BK 22 Pg 38

NOTE:  
 ALL RESIDENTIAL UNIT BALCONIES ARE TO BE LIMITED COMMON ELEMENT.  
 ALL RESIDENTIAL UNITS ARE TO BE PRIVATE ELEMENT.  
 ALL OTHER AREAS TO BE COMMON ELEMENTS UNLESS OTHERWISE NOTED.

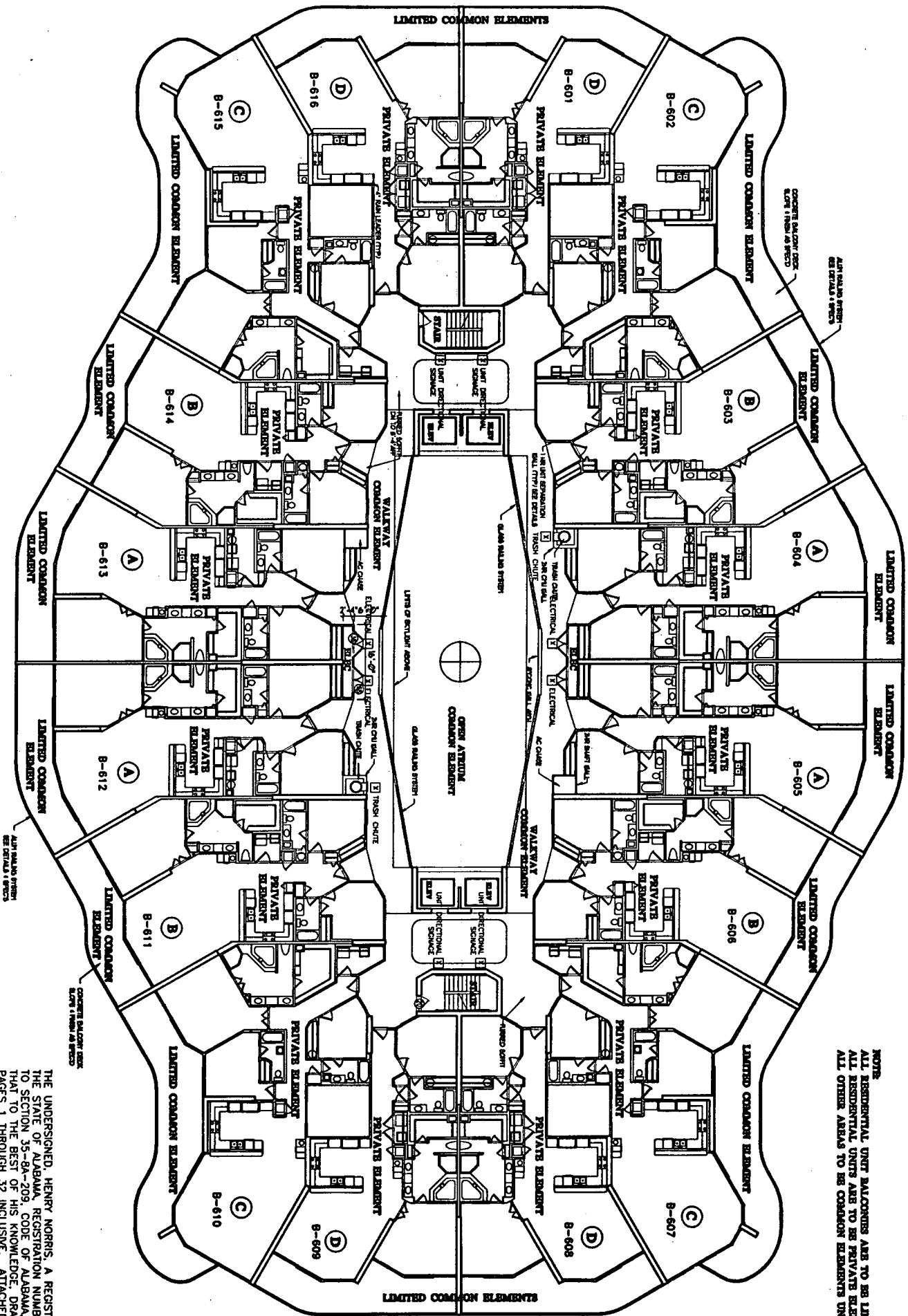

TYPICAL FLOOR PLAN LEVEL 7

THE UNDERSIGNED, HENRY MORRIS, A REGISTERED ARCHITECT IN THE STATE OF ALABAMA, REGISTRATION NUMBER 2665, PURSUANT TO SECTION 35-8A-209, CODE OF ALABAMA, 1975, HEREBY CERTIFIES THAT TO THE BEST OF HIS KNOWLEDGE, DRAWINGS CONSISTING OF PAGES 1 THROUGH 32 INCLUSIVE, ATTACHED TO AND MADE PART OF THE DECLARATION OF CONDOMINIUM OF CARIBE RESORT, FULLY CONTAINS ALL INFORMATION REQUIRED BY SAID SECTION, FULLY AND ACCURATELY DEPICT THE LAYOUT, LOCATIONS, UNIT NUMBERS AND APPROXIMATE DIMENSIONS IN SUFFICIENT DETAIL TO IDENTIFY THE COMMON ELEMENTS, LIMITED COMMON ELEMENTS AND PRIVATE ELEMENTS COMPRISING SUCH UNITS OF CARIBE RESORT CONDOMINIUM, AS BUILT.

*Henry Morris*  
 ALABAMA REGISTRATION NUMBER 2665  
 4/16/02

1 - 1/2" = 1' - 0" SCALE  
 SEE SHEET 8 FOR 1/4" = 1' - 0" SCALE

© HENRY MORRIS & ASSOCIATES, INC.

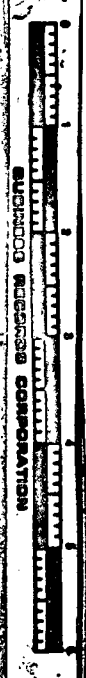

HENRY MORRIS & ASSOCIATES, INC.  
 ARCHITECTURE & ENVIRONMENTAL DESIGN  
 3014 PALATKA  
 FT. PALM AVE.  
 FORT PALM, FLORIDA 33911  
 (850) 432-6111  
 (850) 432-6111  
 FAX (850) 431-9011  
 hmoa@hmoa.com

CARIBE RESORT  
 ORANGE BEACH, ALABAMA

NO. 02  
 OR. 01  
 CHECK. 444  
 DATE. 4/16/02  
 REVISIONS

TYP FLOOR PLAN  
 SHEET  
 8  
 OF 32