

App BK 22 Pg 37



HENRY MORRIS & ASSOC., INC.  
ARCHITECTURE & ENVIRONMENTAL DESIGN  
30 N. PALMER  
PENSACOLA, FLORIDA 32501  
(850) 433-6011  
FAX 433-5011  
henry@hmoa.com

DATE: 4/6/02  
ORDERED: 4/4/02  
JOB NO.: 9908071  
CD: FOL  
ENG: HAN

# CARIBE RESORT

ORANGE BEACH, ALABAMA

TYP FLOOR PLAN SHEET

7

NOTE:  
ALL RESIDENTIAL UNIT BALCONIES ARE TO BE LIMITED COMMON ELEMENT.  
ALL RESIDENTIAL UNITS ARE TO BE PRIVATE ELEMENT.  
ALL OTHER AREAS TO BE COMMON ELEMENTS UNLESS OTHERWISE NOTED.

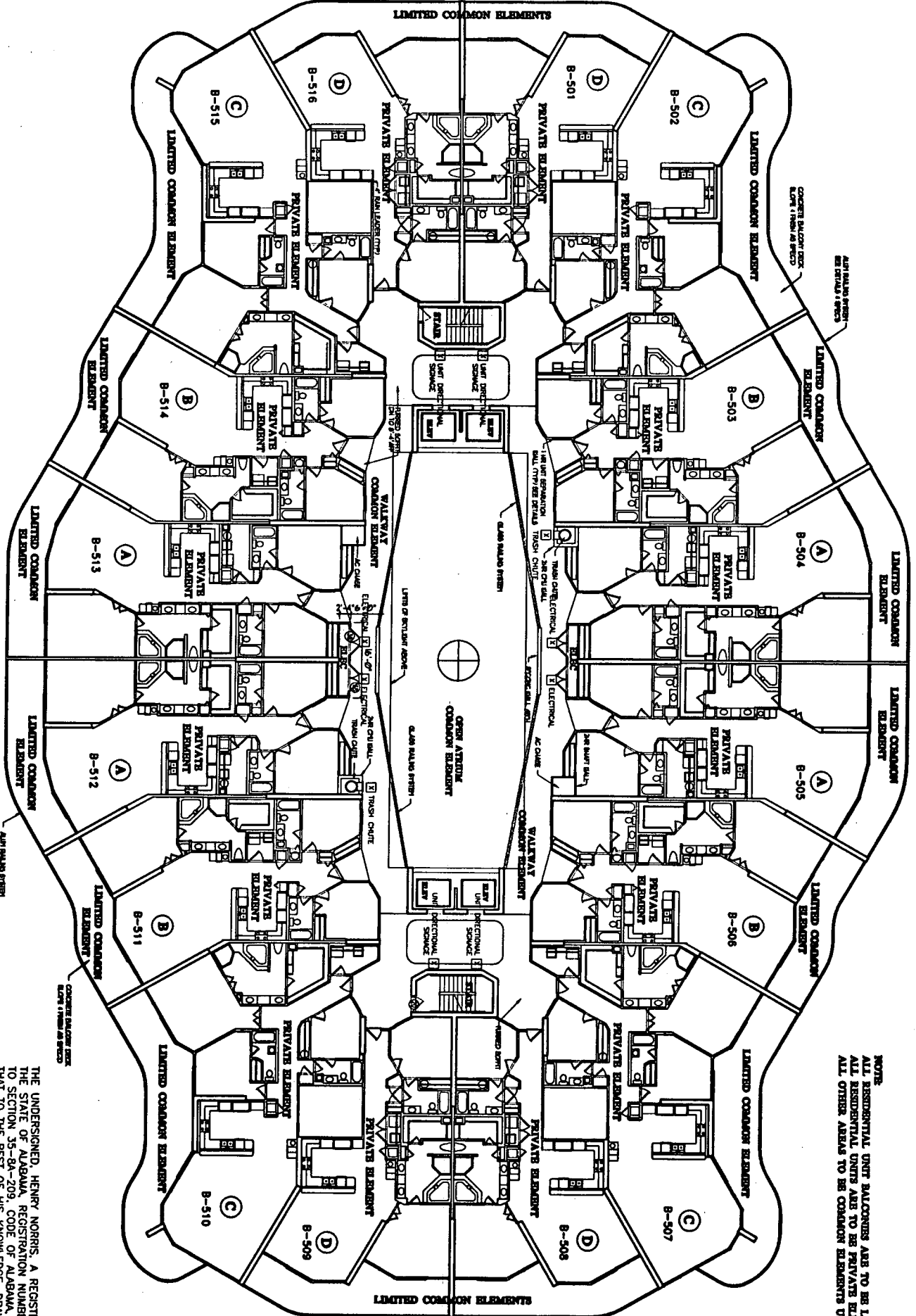

TRASH CHUTE [B]  
IDENTIFY SIGN TYPE & LOCATION  
WORKING NORTH TO BE 00° 00'

### TYPICAL FLOOR PLAN LEVEL 6

THE UNDERSIGNED, HENRY MORRIS, A REGISTERED ARCHITECT IN THE STATE OF ALABAMA, REGISTRATION NUMBER 2665, PURSUANT TO SECTION 35-6A-209, CODE OF ALABAMA, 1975, HEREBY CERTIFIES THAT TO THE BEST OF HIS KNOWLEDGE, DRAWINGS CONSISTING OF PAGES 1 THROUGH 32 INCLUSIVE, ATTACHED TO AND MADE PART OF THE DECLARATION OF CONDOMINIUM OF CARIBE RESORT, A CONDOMINIUM, CONTAINS ALL INFORMATION REQUIRED BY SAID SECTION, FULLY AND ACCURATELY DEPICT THE LAYOUT, LOCATIONS, UNIT NUMBERS AND APPROXIMATE DIMENSIONS IN SUFFICIENT DETAIL TO IDENTIFY THE COMMON ELEMENTS, LIMITED COMMON ELEMENTS AND PRIVATE ELEMENTS COMPRISING SUCH UNITS OF CARIBE RESORT CONDOMINIUM, AS BUILT.

*dm*  
ALABAMA REGISTRATION NUMBER 2665  
DATE

Architectural Series Page 6 of 23

HENRY MORRIS & ASSOCIATES, INC.

