

App. BK 22 pg 46

THE UNDERSIGNED, HENRY MORRIS, A REGISTERED ARCHITECT IN THE STATE OF ALABAMA, REGISTRATION NUMBER 2665, PURSUANT TO SECTION 38-8A-209, CODE OF ALABAMA, 1975, HEREBY CERTIFIES THAT I HAVE EXAMINED THE DRAWINGS CONSISTING OF PAGES 1 THROUGH 32 IN CONNECTION WITH THE DECLARATION OF CONDOMINIUM OF CARIBE RESORT, FULLY AND ACCURATELY DEPICT THE LAYOUT, LOCATIONS, UNIT NUMBERS AND DIMENSIONS OF THE COMMON ELEMENTS AND UNIT ELEMENTS COMPRISED IN SUCH UNITS OF CARIBE RESORT CONDOMINIUM, AS BUILT.

*Henry Morris*  
 ALABAMA REGISTRATION NUMBER 2665  
 DATE 4/1/02

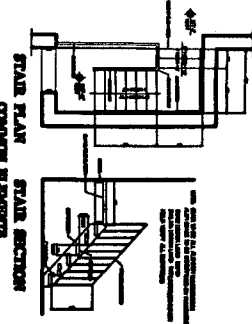
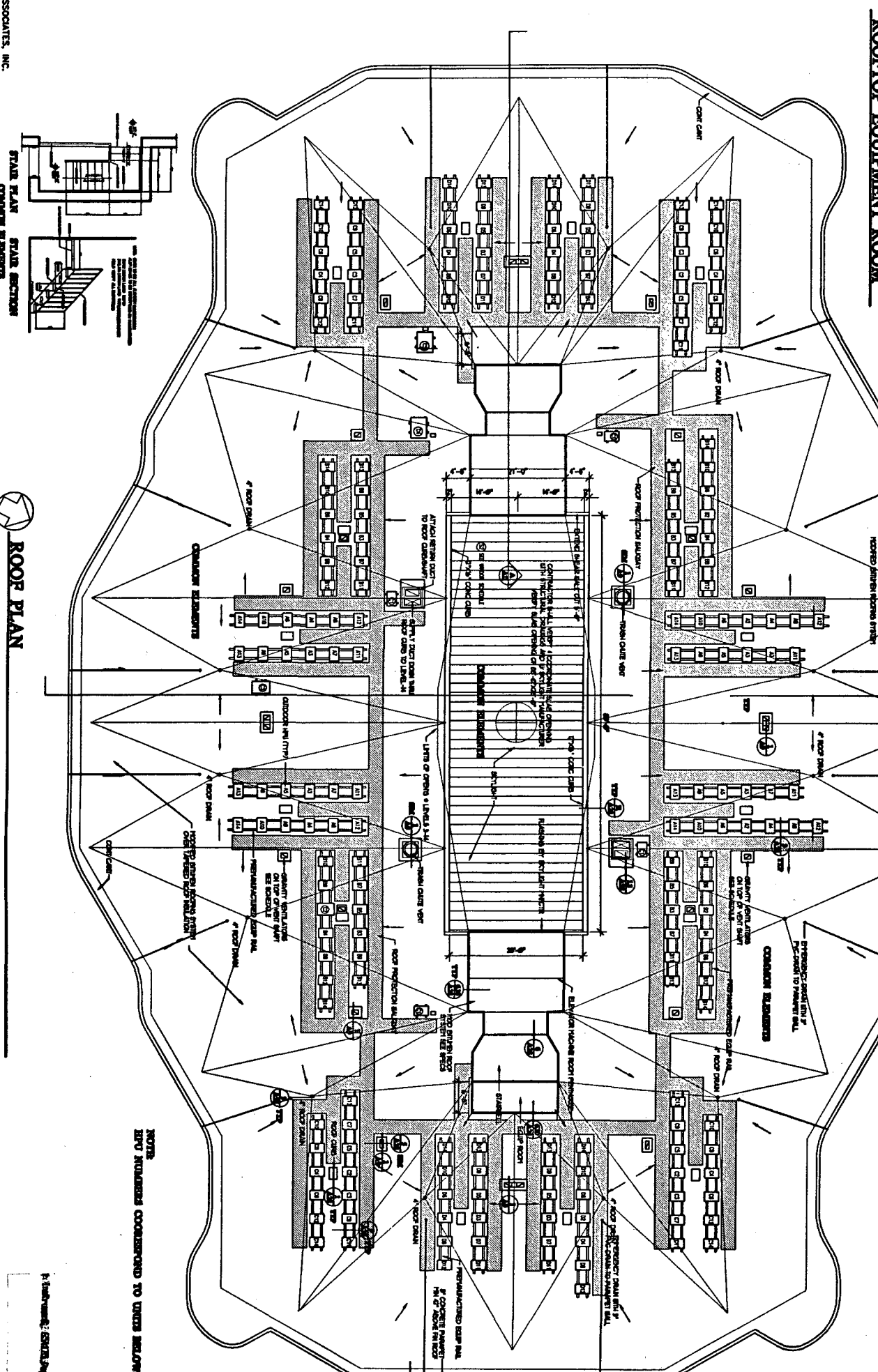
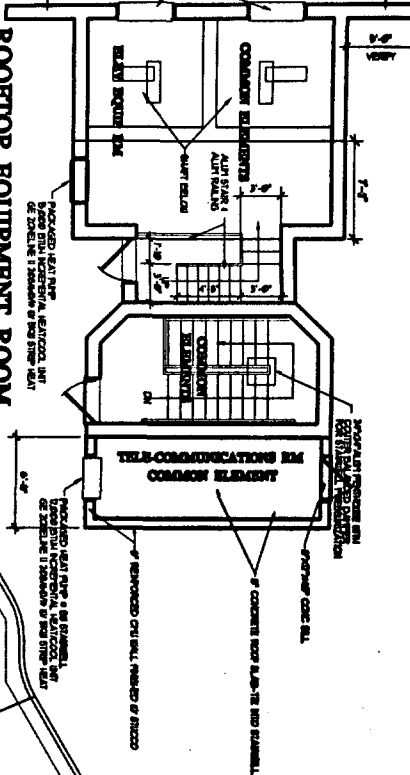

NOTE: REV NUMBERS CORRESPOND TO UNITS BELOW.

1:8 Scale: SEE AUGUST 1981



**HENRY MORRIS & ASSOC., INC.**  
 ARCHITECTURE & ENVIRONMENTAL DESIGN  
 30 N. PALMER  
 FLORENCE, ALABAMA 36833  
 (205) 453-0201  
 FAX (205) 453-0201  
 hma@hmadallas.com

**CARIBE RESORT**  
 ORANGE BEACH, ALABAMA

JOB NO.: 090807  
 CD: PHL  
 CHECK: JMM  
 DATE: 4/8/02  
 REVISION:

ROOF PLAN  
 SHEET  
**16**  
 OF 32

© HENRY MORRIS & ASSOCIATES, INC.