

**ROOM NAME LEGEND:**

- AC - HVAC & W.H. CLOSET
  - B - BATHROOM
  - BR - BEDROOM
  - K - KITCHEN
  - L - LAUNDRY ROOM
  - LR - LIVING ROOM
  - LCE - LIMITED COMMON ELEMENT
  - ST - STORAGE ROOM
- (NOTE CLOSETS ARE NOT NOTED)

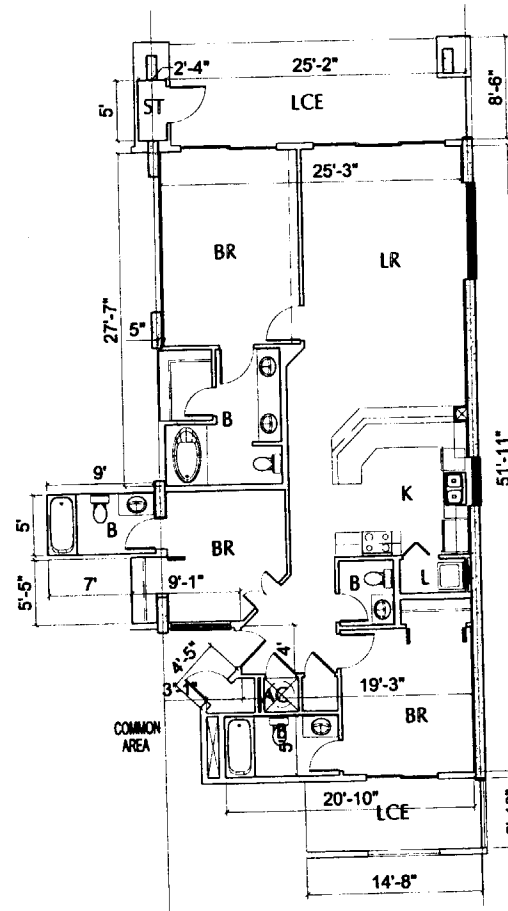

**UNIT "A"**  
 (LEVEL 1 ONLY)  
 UNIT: A110  
 INTERIOR AREA: 1,321 sqft.

**NOTES:**

THIS IS TO CERTIFY THAT ALL OF THE CONDOMINIUM PROPERTY AND ALL STRUCTURES OF THE CONDOMINIUM ARE LOCATED WITHIN FLOOD ZONE "B" & "C" AS DETERMINED BY THE U.S. DEPARTMENT OF HOUSING AND URBAN DEVELOPMENT.

ALL OF THE REAL PROPERTY DESCRIBED ON THE PLANS IS SUBJECT TO SPECIAL DECLARANT RIGHTS AS SET OUT IN THE DECLARATION OF CONDOMINIUM OF BEACH CLUB PARCEL 9, A CONDOMINIUM.



DAG ARCHITECTS INC  
 P.O. BOX 1395 DESTIN, FLORIDA 32540  
 TELEPHONE: 850-837-8152 FAX: 850-654-4276  
 AA-C000745

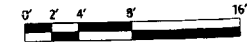

**EXHIBIT "B" PAGE 24**  
 ATTACH TO AND MADE A PART OF THE DECLARATION OF CONDOMINIUM OF BEACH CLUB PARCEL 9, A CONDOMINIUM.

**BEACH CLUB PARCEL 9,**  
**A CONDOMINIUM**  
**FORT MORGAN PARADISE JOINT VENTURE,**  
**AN ALABAMA PARTNERSHIP**