

This drawing is the property of Hatch Mott MacDonald Florida, LLC, and may not be reproduced without written permission.

OR BK 5519 P61269
 Escambia County, Florida
 INSTRUMENT 2004-299279

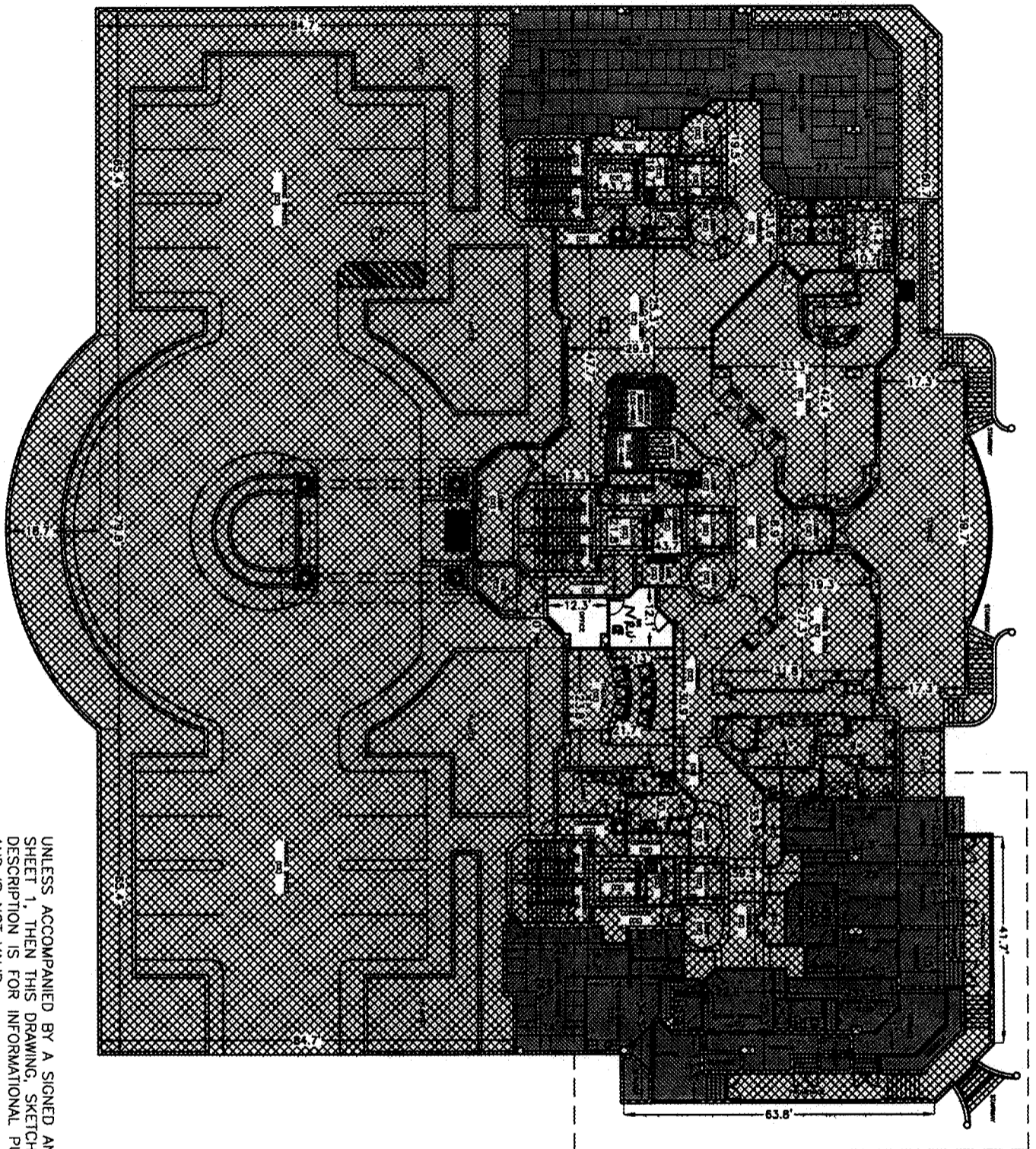

SEE SHEET 12 FOR
 CABANA UNIT DETAIL

**INDIGO CONDOMINIUM
 (PHASE 1)
 AMENITY LEVEL
 FLOOR 2**



0 30
 Scale: 1" = 30'

UNLESS ACCOMPANIED BY A SIGNED AND SEALED SHEET 1, THEN THIS DRAWING, SKETCH, PLAT, MAP OR DESCRIPTION IS FOR INFORMATIONAL PURPOSES ONLY AND IS NOT VALID.

-  = COMMON ELEMENT
-  = LIMITED COMMON ELEMENT TO APURTMENTANT RESIDENTIAL UNIT
-  = LIMITED COMMON ELEMENT TO APURTMENTANT NON-RESIDENTIAL UNIT

 Hatch Mott MacDonald	Hatch Mott MacDonald Florida, LLC Architects Engineers Surveyors Certificate of Authorization: LA - 0006733 5111 North 12th Avenue (222nd) / P. O. Box 2018 (2213-2618) Tallahassee, Florida Telephone: (850) 944-5711 or (727) 444-4188		DESIGNED BY:	G. EDWARDS	PROJECT SURVEYOR:	R.S. COLOCADO	DATE:	09-14-2004	H.A.M. PROJECT NUMBER:	201910	SHEET:	5 OF 23
	DRAWN BY:	M. BONIFAY	PROJECT MANAGER:	M. BONIFAY	LAST REVISED:							