

THE UNDERSIGNED, HENRY NORRIS, A REGISTERED ARCHITECT IN THE STATE OF ALABAMA, REGISTRATION NUMBER 2665, PURSUANT TO SECTION 35-8A-209, CODE OF ALABAMA, 1975, HERBY CERTIFIES THAT TO THE BEST OF HIS KNOWLEDGE, DRAWINGS CONSISTING OF PAGES 1 THROUGH 11 INCLUSIVE, ATTACHED TO AND MADE PART OF THE DECLARATION OF CONDOMINIUM OF TIDEWATER, A CONDOMINIUM, CONTAINS ALL INFORMATION REQUIRED BY SAID SECTION, FULLY AND ACCURATELY DEPICT THE LAYOUT, LOCATIONS, UNIT NUMBERS AND APPROXIMATE DIMENSIONS IN SUFFICIENT DETAIL TO IDENTIFY THE COMMON ELEMENTS, LIMITED COMMON ELEMENTS AND PRIVATE ELEMENTS COMPRISING SUCH UNITS OF TIDEWATER CONDOMINIUM, AS BUILT.

H.N.
 ALABAMA REGISTRATION NUMBER 2665
 1/9/99
 DATE

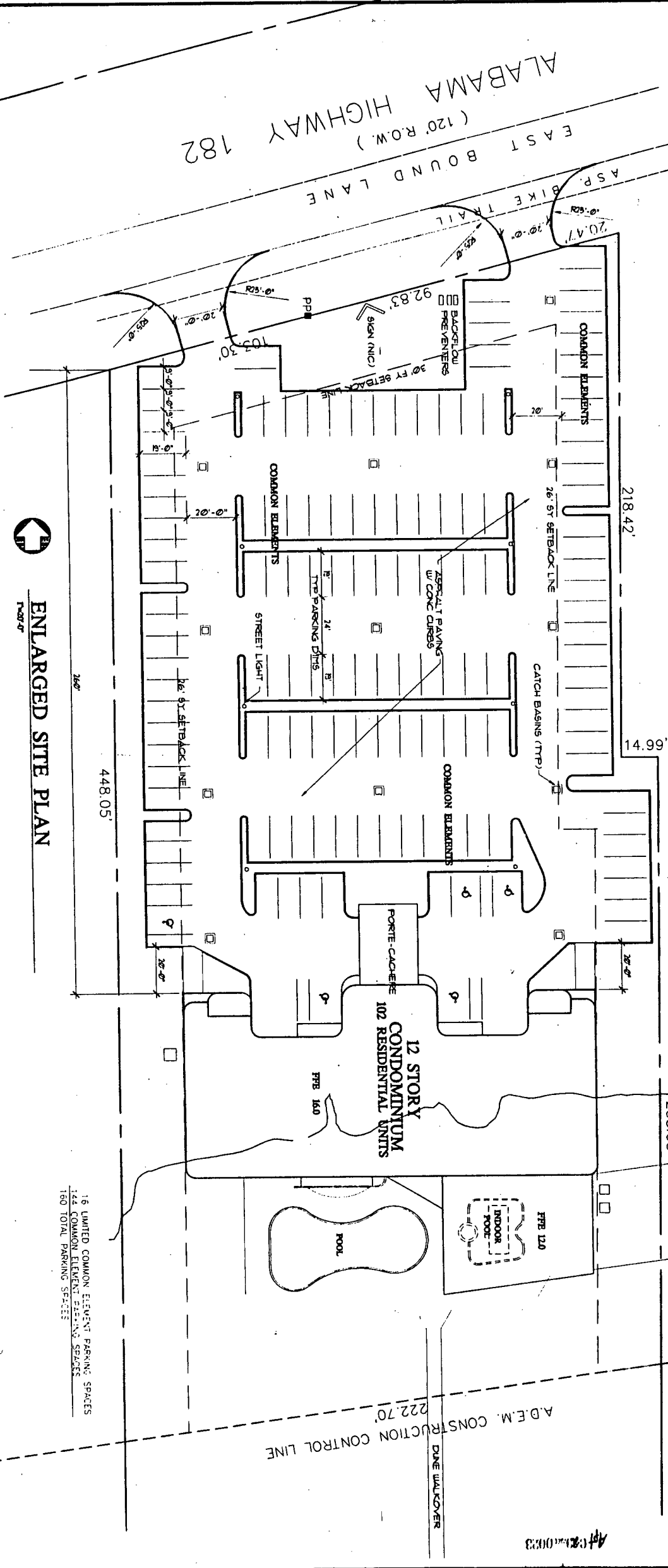

ENLARGED SITE PLAN
 1/2" = 1' - 0"

16 LIMITED COMMON ELEMENT PARKING SPACES
 144 COMMON ELEMENT PARKING SPACES
 180 TOTAL PARKING SPACES

HN

HENRY NORRIS & ASSOC., INC.

ARCHITECTURE & ENVIRONMENTAL DESIGN

30 N. PALMBOX PENSACOLA, FLORIDA 32501

(904) 432-2001 FAX 432-2000

TIDEWATER
 CONDOMINIUM &
 ORANGE BEACH, ALABAMA

JOB NO.: 095711
 CAD: MGL/m
 CHECKER: HN
 DATE: 11/5/99
 REVISION:

SHEET
 1

© HENRY NORRIS & ASSOCIATES, INC.