

MISC0082 PAGE 0044

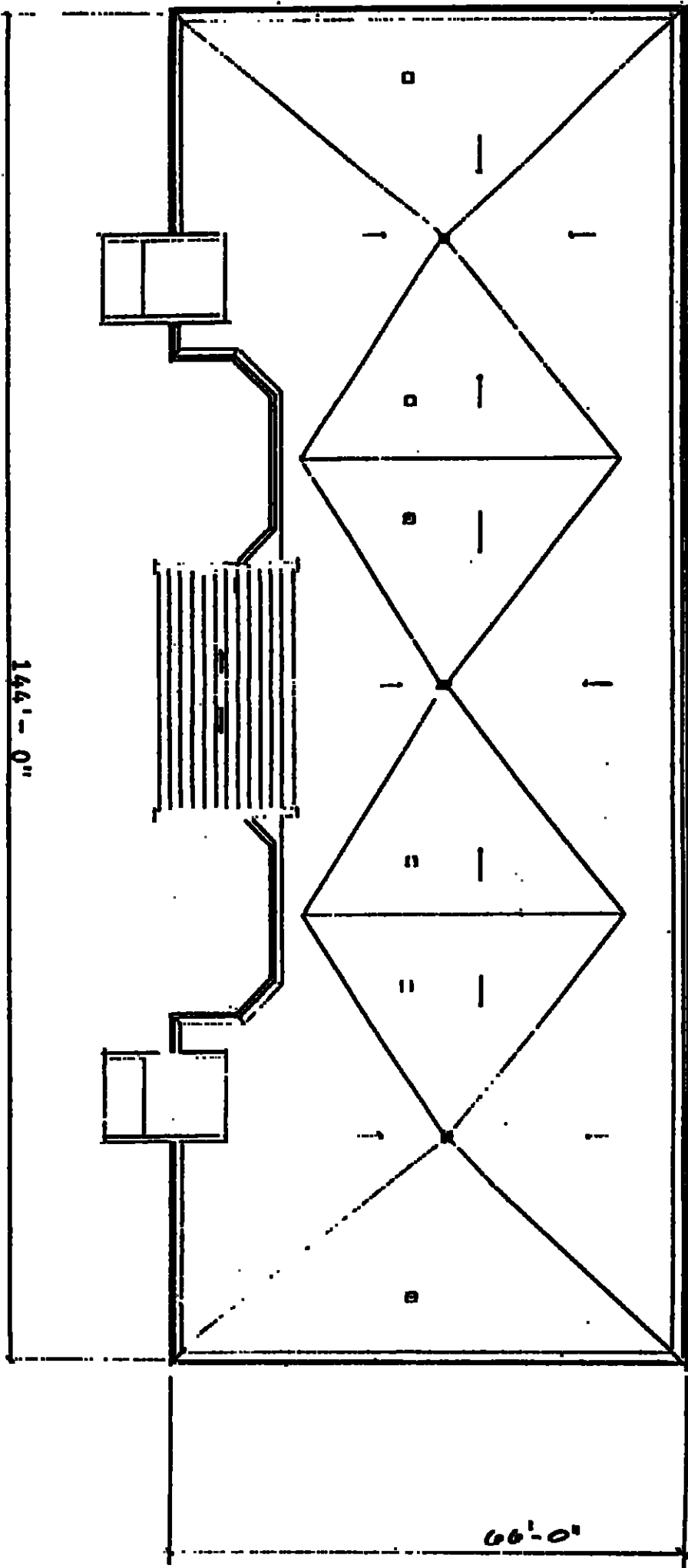

ALL OF THE REAL PROPERTY DESCRIBED ON THE PLANS IS SUBJECT TO DEVELOPMENT RIGHTS AS SET OUT IN THE DECLARATION OF CONDOMINIUM OF OCEAN HOUSE, A CONDOMINIUM. THE DEVELOPER RESERVES THE RIGHT TO:
(1) ADD REAL ESTATE TO THE CONDOMINIUM;
(2) CREATE SMITS, COMMON ELEMENTS, OR LIMITED COMMON ELEMENTS;
(3) SUBDIVIDE UNITS, OR CONVERT UNITS TO COMMON ELEMENTS.

COMPOSITE ROOF PLAN PHASE I
OCEAN HOUSE, A CONDOMINIUM