

Appl. BK 22 pg 43

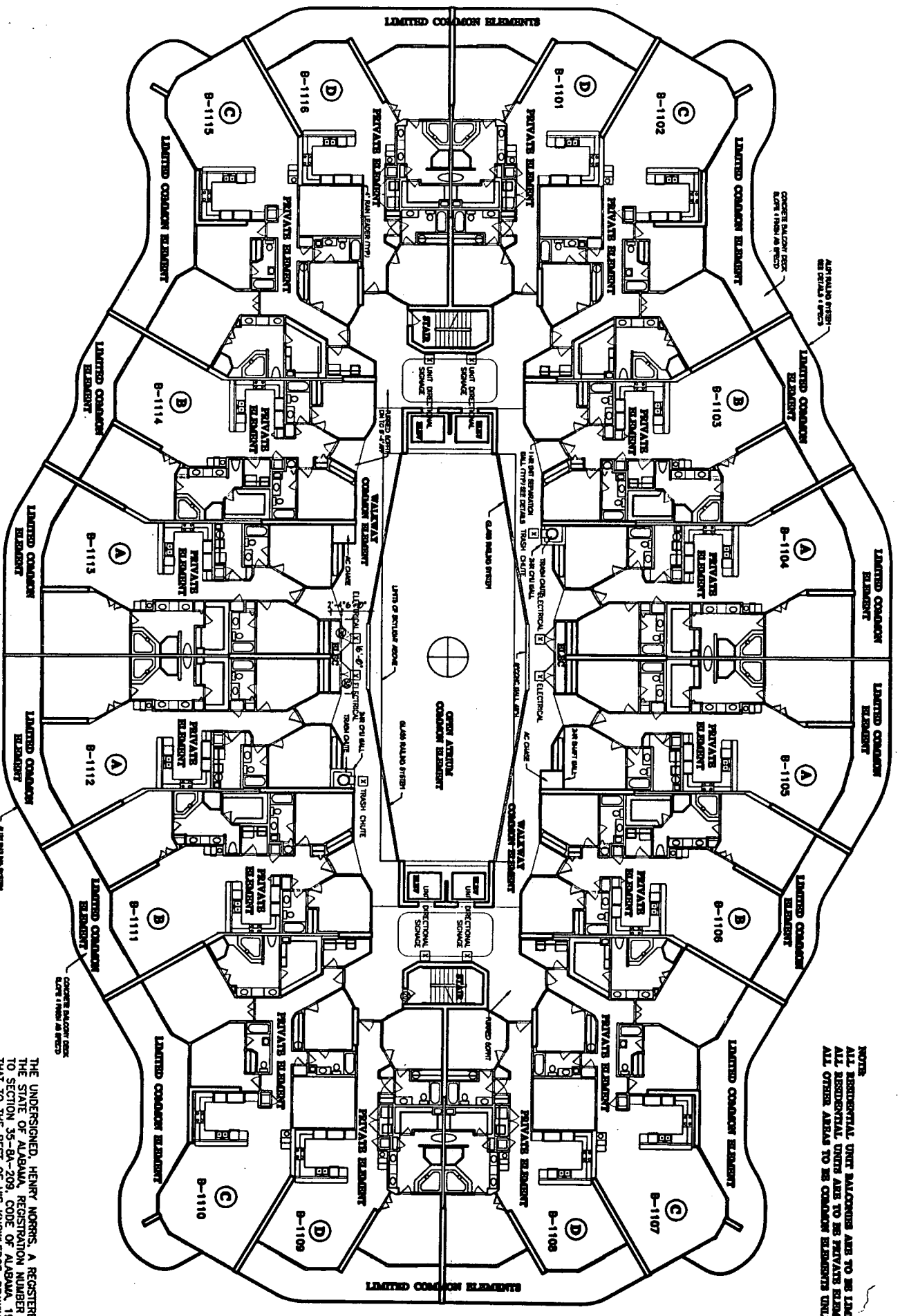

TYPICAL FLOOR PLAN LEVEL 12

NOTES:
 ALL RESIDENTIAL UNIT BALCONIES ARE TO BE LIMITED COMMON ELEMENT.
 ALL RESIDENTIAL UNITS ARE TO BE PRIVATE ELEMENT.
 ALL OTHER AREAS TO BE COMMON ELEMENTS UNLESS OTHERWISE NOTED.

THE UNDERSIGNED, HENRY NORRIS, A REGISTERED ARCHITECT IN THE STATE OF ALABAMA, REGISTRATION NUMBER 2665, PURSUANT TO SECTION 35-8A-209, CODE OF ALABAMA, 1975, HEREBY CERTIFY THAT TO THE BEST OF HIS KNOWLEDGE, BELIEF AND FAITH, THE INFORMATION CONTAINED HEREIN IS TRUE AND CORRECT. THE DECLARATION OF CONDOMINIUM OF CARIBE RESORT, MADE PART OF THIS PLAN, IS ATTACHED TO THIS PLAN, AND IS A PART OF THIS PLAN AND ACCURATELY DEPICT THE LAYOUT, LOCATIONS, UNIT NUMBERS AND APPROXIMATE DIMENSIONS IN SUFFICIENT DETAIL TO IDENTIFY THE COMMON ELEMENTS, LIMITED COMMON ELEMENTS AND PRIVATE ELEMENTS COMPRISING SUCH UNITS OF CARIBE RESORT CONDOMINIUM, AS BUILT.

ALABAMA REGISTRATION NUMBER 2665

DATE 4/1/02
 SHEET 13 OF 23



HENRY NORRIS & ASSOC., INC.
 ARCHITECTURE & ENVIRONMENTAL DESIGN

30 N. PALMER
 FENSMORE, ALABAMA 36801
 (256) 432-6911
 FAX (256) 432-6911

CARIBE RESORT
 ORANGE BEACH, ALABAMA

AS BY: GROWBET
 CD: TVAL
 ORDER: 1444
 DATE: 4/1/02
 REVISIONS:

TYP FLOOR PLAN

13