

ROOM NAME LEGEND:

- AC - HVAC & W.H. CLOSET
 - B - BATHROOM
 - BR - BEDROOM
 - K - KITCHEN
 - L - LAUNDRY ROOM
 - D - DINING ROOM
 - LR - LIVING ROOM
 - LCE - LIMITED COMMON ELEMENT
 - ST - STORAGE ROOM
- (NOTE: CLOSETS ARE NOT NOTED)

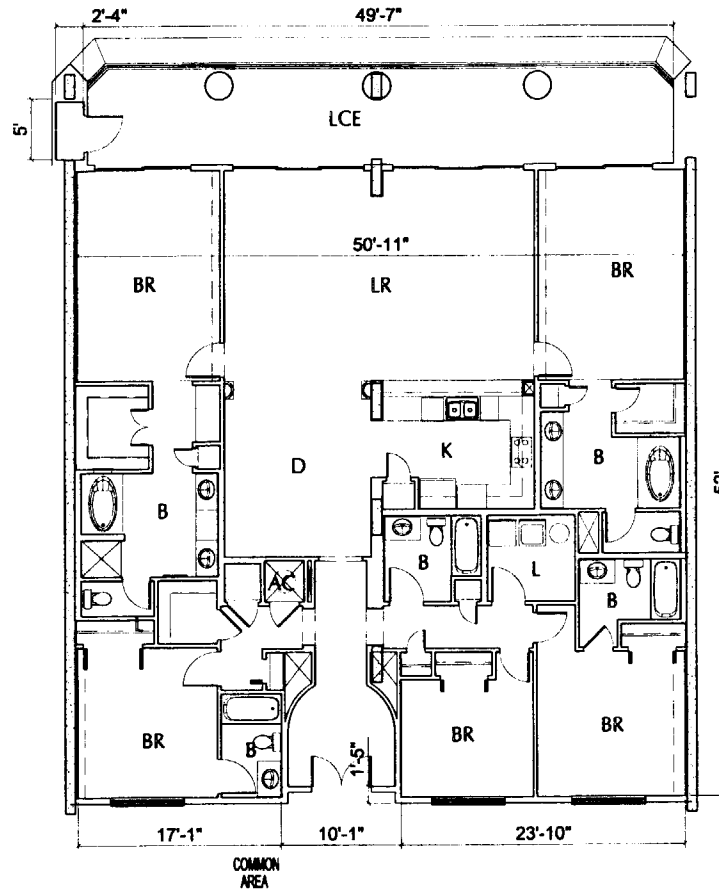

NOTES:

THIS IS TO CERTIFY THAT ALL OF THE CONDOMINIUM PROPERTY AND ALL STRUCTURES OF THE CONDOMINIUM ARE LOCATED WITHIN FLOOD ZONE "B" & "C" AS DETERMINED BY THE U.S. DEPARTMENT OF HOUSING AND URBAN DEVELOPMENT.

ALL OF THE REAL PROPERTY DESCRIBED ON THE PLANS IS SUBJECT TO SPECIAL DECLARANT RIGHTS AS SET OUT IN THE DECLARATION OF CONDOMINIUM OF BEACH CLUB PARCEL 9, A CONDOMINIUM

UNIT "G-2"

(LEVEL 16 ONLY)

UNIT: AC305

INTERIOR AREA: 2,636 sq.ft.



DAG ARCHITECTS INC.
 P.O. BOX 1395 DESTIN, FLORIDA 32540
 TELEPHONE: 850-837-8152 FAX: 850-654-4276
 AA-C000745

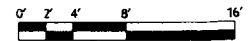

EXHIBIT "B" PAGE 64

ATTACH TO AND MAKE A PART OF THE DECLARATION OF CONDOMINIUM OF BEACH CLUB PARCEL 9, A CONDOMINIUM

**BEACH CLUB PARCEL 9,
 A CONDOMINIUM
 FORT MORGAN PARADISE JOINT VENTURE,
 AN ALABAMA PARTNERSHIP**