

ROOM NAME LEGEND:

- AC - HVAC & W.H. CLOSET
 - B - BATHROOM
 - BR - BEDROOM
 - K - KITCHEN
 - L - LAUNDRY ROOM
 - LR - LIVING ROOM
 - LCE - LIMITED COMMON ELEMENT
 - ST - STORAGE ROOM
- (NOTE: CLOSETS ARE NOT NOTED)

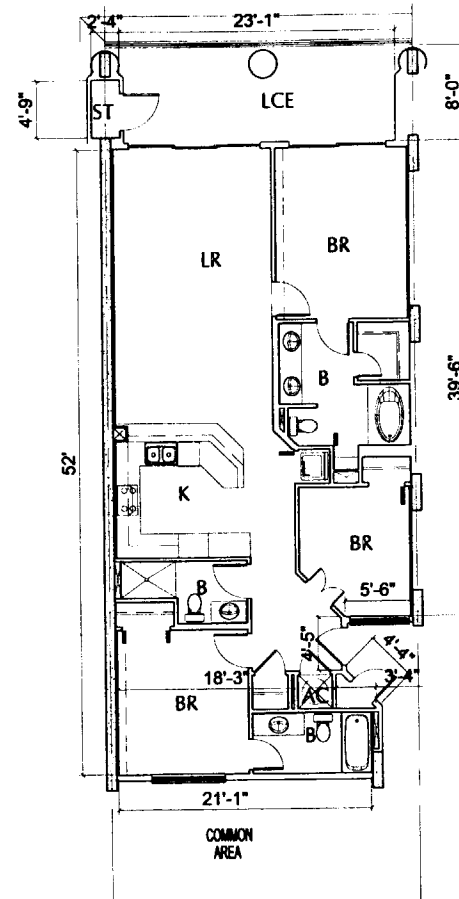

UNIT "A-4"
 (LEVEL 1B ONLY)
 UNIT: AC507
 INTERIOR AREA: 1,218 sq.ft.

BEACH CLUB PARCEL 9,
A CONDOMINIUM
FORT MORGAN PARADISE JOINT VENTURE,
AN ALABAMA PARTNERSHIP



DAG ARCHITECTS INC
 P.O. BOX 1395 DESTIN, FLORIDA 32540
 TELEPHONE: 850-837-8152 FAX: 850-454-4276
 AA-C000745

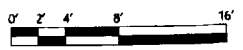

EXHIBIT "B" PAGE 41
 ATTACH TO AND MADE A PART OF THE
 DECLARATION OF CONDOMINIUM OF
 BEACH CLUB PARCEL 9, A CONDOMINIUM.

NOTES:

THIS IS TO CERTIFY THAT ALL OF THE CONDOMINIUM PROPERTY AND ALL STRUCTURES OF THE CONDOMINIUM ARE LOCATED WITHIN FLOOD ZONE "B" & "C" AS DETERMINED BY THE U.S. DEPARTMENT OF HOUSING AND URBAN DEVELOPMENT.

ALL OF THE REAL PROPERTY DESCRIBED ON THE PLANS IS SUBJECT TO SPECIAL DECLARANT RIGHTS AS SET OUT IN THE DECLARATION OF CONDOMINIUM OF BEACH CLUB PARCEL 9, A CONDOMINIUM.