

App. BK. 22 pg 60

THE UNDERSIGNED, HENRY MORRIS, A REGISTERED ARCHITECT IN THE STATE OF ALABAMA, REGISTRATION NUMBER 2665, PURSUANT TO THE STATUTE, 38-2-209, CODE OF ALABAMA, 1975, HEREBY CERTIFIES THAT THE SEVEN (7) PAGES OF ARCHITECTURAL DRAWINGS CONSISTING OF PAGES 1 THROUGH 7, INCLUDING THE DECLARATION OF CONDOMINIUM OF CARIBE RESORT, A CONDOMINIUM, CONTAINS ALL INFORMATION REQUIRED BY SAID SECTION, FULLY AND ACCURATELY DEPICT THE LAYOUT, LOCATIONS, UNIT NUMBERS AND APPROXIMATE DIMENSIONS IN SUFFICIENT DETAIL TO IDENTIFY THE COMMON ELEMENTS, LIMITED COMMON ELEMENTS AND PRIVATE ELEMENTS COMPRISING SUCH UNITS OF CARIBE RESORT CONDOMINIUM, AS BUILT.

H.M.
 ALABAMA REGISTRATION NUMBER 2665
 DATE 4/10/82

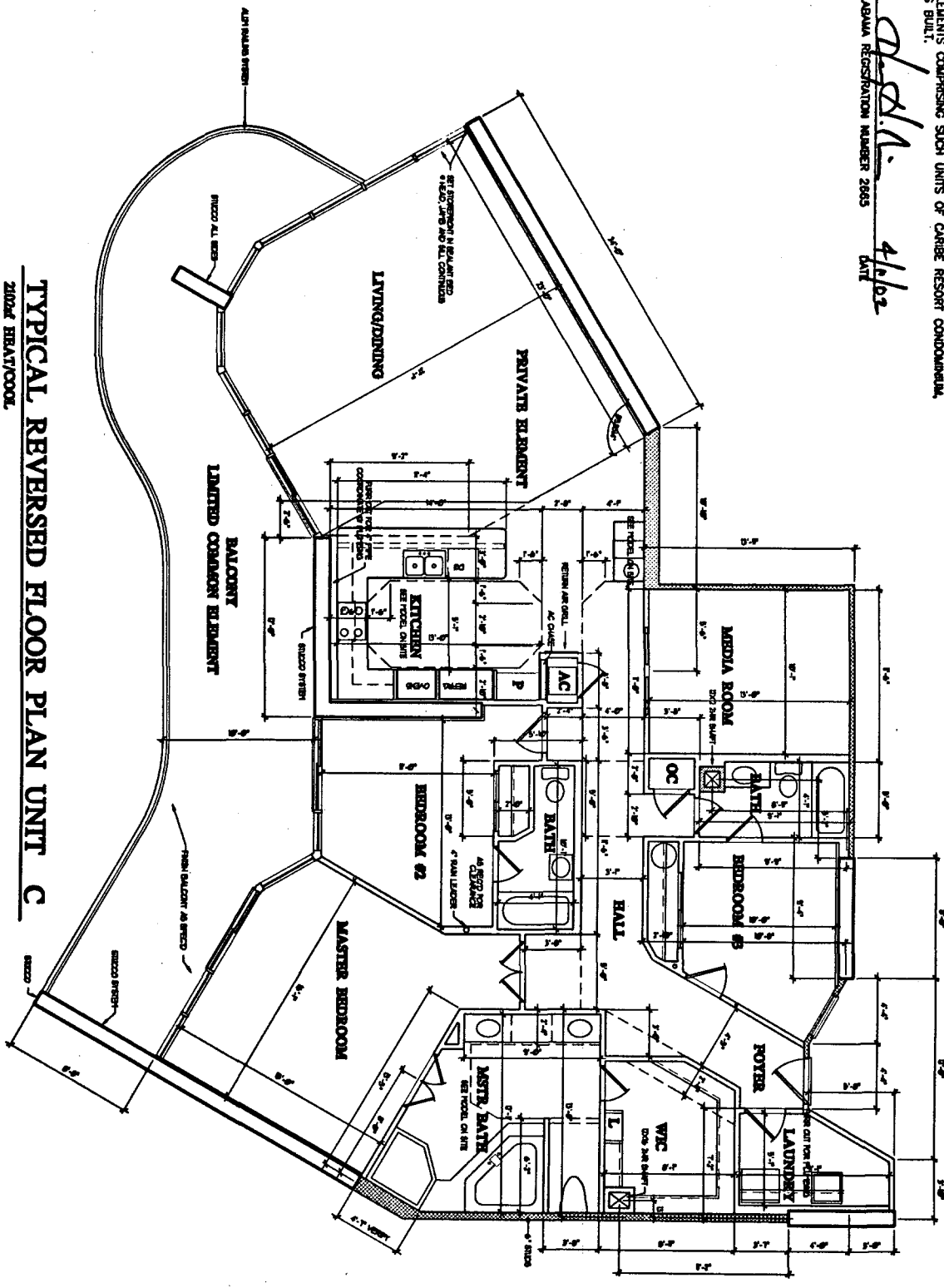

TYPICAL REVERSED FLOOR PLAN UNIT C
 2100' BRAYCOOL
 3700' BALCONY
 2894' TOTAL

NOTE
 ALL RESIDENTIAL UNIT BALCONIES ARE TO BE LIMITED COMMON ELEMENT.
 ALL RESIDENTIAL UNITS ARE TO BE PRIVATE ELEMENT.
 ALL OTHER AREAS TO BE COMMON ELEMENTS UNLESS OTHERWISE NOTED.

Instrument: SUDA Page 21 of 22

HN

HENRY MORRIS & ASSOC., INC.
 ARCHITECTURE & ENVIRONMENTAL DESIGN

30 N. PALMER
 PRINCETON, FLORIDA 32069

650 62-001
 3142 65-001

CARIBE RESORT
 ORANGE BEACH, ALABAMA

DES. NO.: 090307
 OR. NO.: 1041
 ORDER: 1441
 DATE: 4/4/82
 EXPOS:

UNIT C REVERSED
 SHEET

30

© HENRY MORRIS & ASSOCIATES, INC.

