

APR 22 1984

NOTE:  
 ALL RESIDENTIAL UNIT BALCONIES ARE TO BE LIMITED COMMON ELEMENT.  
 ALL RESIDENTIAL UNITS ARE TO BE PRIVATE ELEMENT.  
 ALL OTHER AREAS TO BE COMMON ELEMENTS UNLESS OTHERWISE NOTED.

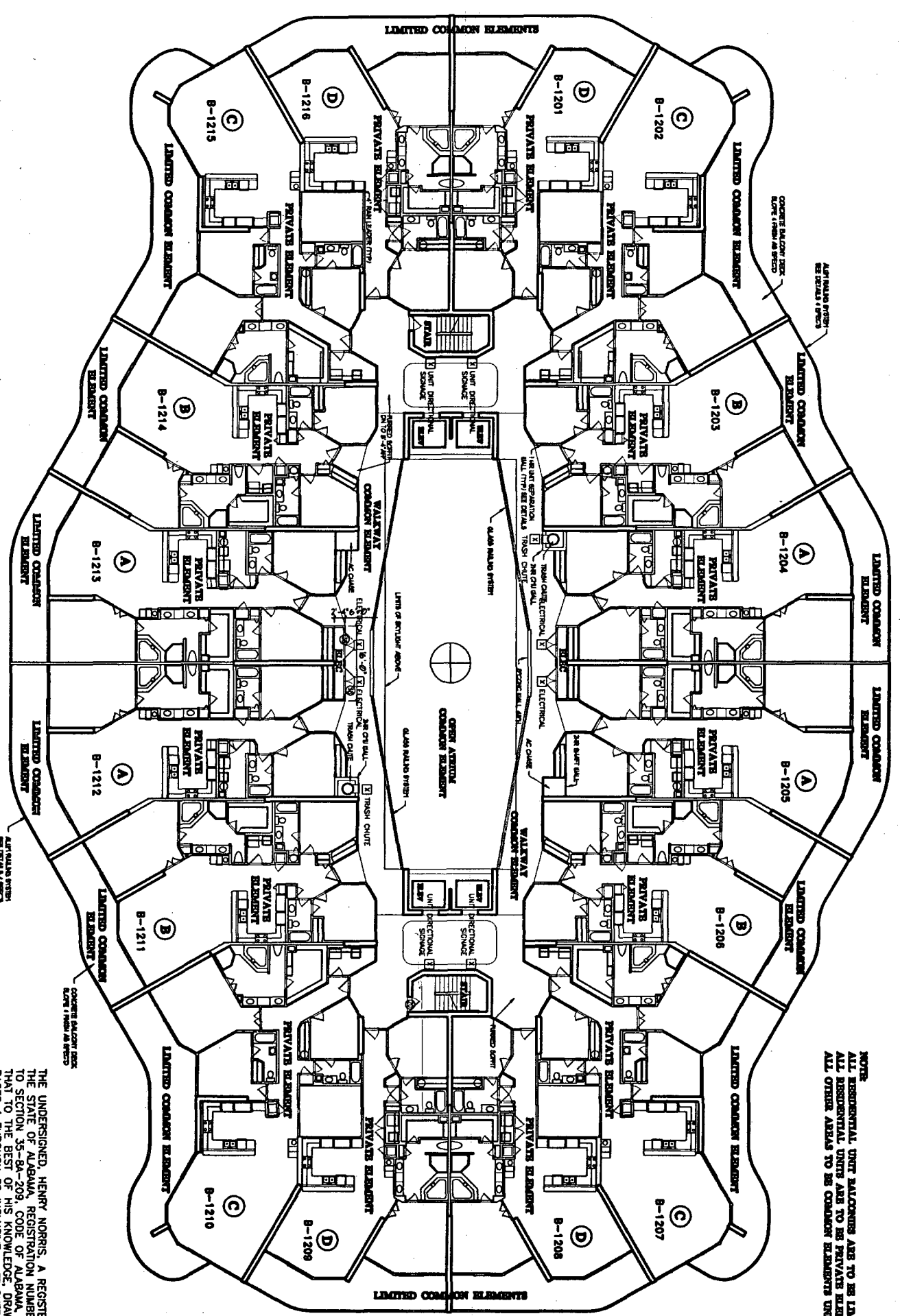

TYPICAL FLOOR PLAN LEVEL 13

THE UNDERSIGNED, HENRY NORRIS, A REGISTERED ARCHITECT IN THE STATE OF ALABAMA, REGISTRATION NUMBER 2665, PURSUANT TO SECTION 35-8A-209, CODE OF ALABAMA, 1975, HEREBY CERTIFIES THAT TO THE BEST OF HIS KNOWLEDGE, DRAWINGS CONSISTING OF PAGES 1 THROUGH 32 INCLUSIVE, ATTACHED TO AND MADE PART OF THE DECLARATION OF CONDOMINIUM OF CARIBE RESORT, A CONDOMINIUM, CONTAINS ALL INFORMATION REQUIRED BY SAID SECTION, FULLY AND ACCURATELY DEPICT THE LAYOUT, LOCATIONS, UNIT NUMBERS AND APPROPRIATE DIMENSIONS IN SUFFICIENT DETAIL TO IDENTIFY THE COMMON ELEMENTS, LIMITED COMMON ELEMENTS AND PRIVATE ELEMENTS COMPRISING SUCH UNITS OF CARIBE RESORT CONDOMINIUM, AS BUILT.

ALABAMA REGISTRATION NUMBER 2665

4/1/82

Sheet 14 of 20



HENRY NORRIS & ASSOCIATES, INC.



HENRY NORRIS & ASSOC., INC.  
 ARCHITECTURE & ENVIRONMENTAL DESIGN

30 N. PALMBOCK  
 PENSACOLA, FLORIDA 32501  
 (904) 433-0311  
 FAX (904) 433-0311  
 Henry@hna.com

CARIBE RESORT  
 ORANGE BEACH, ALABAMA

DESIGNER: HENRY NORRIS & ASSOCIATES, INC.  
 CHECKED: HENRY NORRIS  
 DATE: 4/1/82

TYP FLOOR PLAN  
 SHEET 14