

Apr 22 1992

NOTE:  
 ALL RESIDENTIAL UNIT BALCONIES ARE TO BE LIMITED COMMON ELEMENT.  
 ALL RESIDENTIAL UNITS ARE TO BE PRIVATE ELEMENT.  
 ALL OTHER AREAS TO BE COMMON ELEMENTS UNLESS OTHERWISE NOTED.

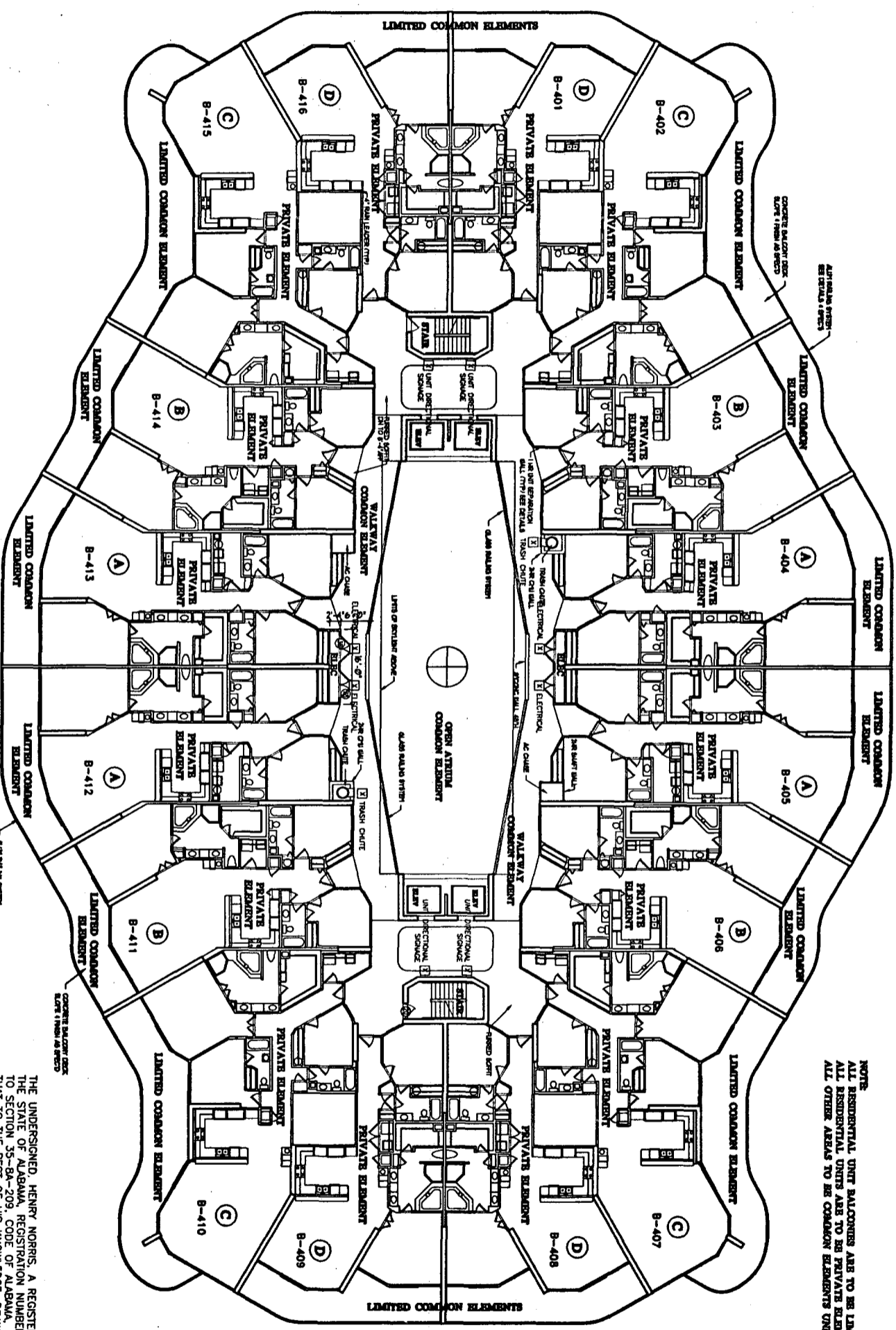

TYPICAL FLOOR PLAN LEVEL 5

THE UNDERSIGNED, HENRY NORRIS, A REGISTERED ARCHITECT IN THE STATE OF ALABAMA, REGISTRATION NUMBER 2665, PURSUANT TO SECTION 35-8A-209, CODE OF ALABAMA, 1975, HEREBY CERTIFIES THAT TO THE BEST OF HIS KNOWLEDGE, DRAWINGS CONSISTING OF PAGES 1 THROUGH 32 INCLUSIVE, ATTACHED TO AND MADE PART OF THE DECLARATION OF CONDOMINIUM OF CARIBE RESORT, A CONDOMINIUM, CONTAINS ALL INFORMATION REQUIRED BY SAID SECTION, FULLY AND ACCURATELY DEPICT THE LAYOUT, LOCATIONS, UNIT NUMBERS AND APPROXIMATE DIMENSIONS IN SUFFICIENT DETAIL TO IDENTIFY THE COMMON ELEMENTS, LIMITED COMMON ELEMENTS AND PRIVATE ELEMENTS COMPRISING SUCH UNITS OF CARIBE RESORT CONDOMINIUM, AS BUILT.

*[Signature]*  
 ALABAMA REGISTRATION NUMBER 2665  
 DATE 4/11/92

Sheet 6 of 23

HENRY NORRIS & ASSOCIATES, INC.

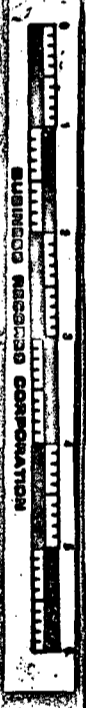

**HN**

HENRY NORRIS & ASSOCIATES, INC.

ARCHITECTURE & ENVIRONMENTAL DESIGN

30 N. PALMFOX  
 PENSACOLA,  
 FLORIDA 32501

(850) 433-4011  
 FAX 433-5011  
 henny@hennya.com

**CARIBE RESORT**  
 ORANGE BEACH, ALABAMA

433 N.L. 09/08/91  
 C.R. T.O.L.  
 C.R. H.H.N.  
 DATE 4/24/92  
 REVISION

TYP FLOOR PLAN  
 SHEET  
**6**  
 OF 23