

SUBJECT TO DEVELOPMENT RIGHTS

OLD RIVER

Opt. BK 22 pg 31

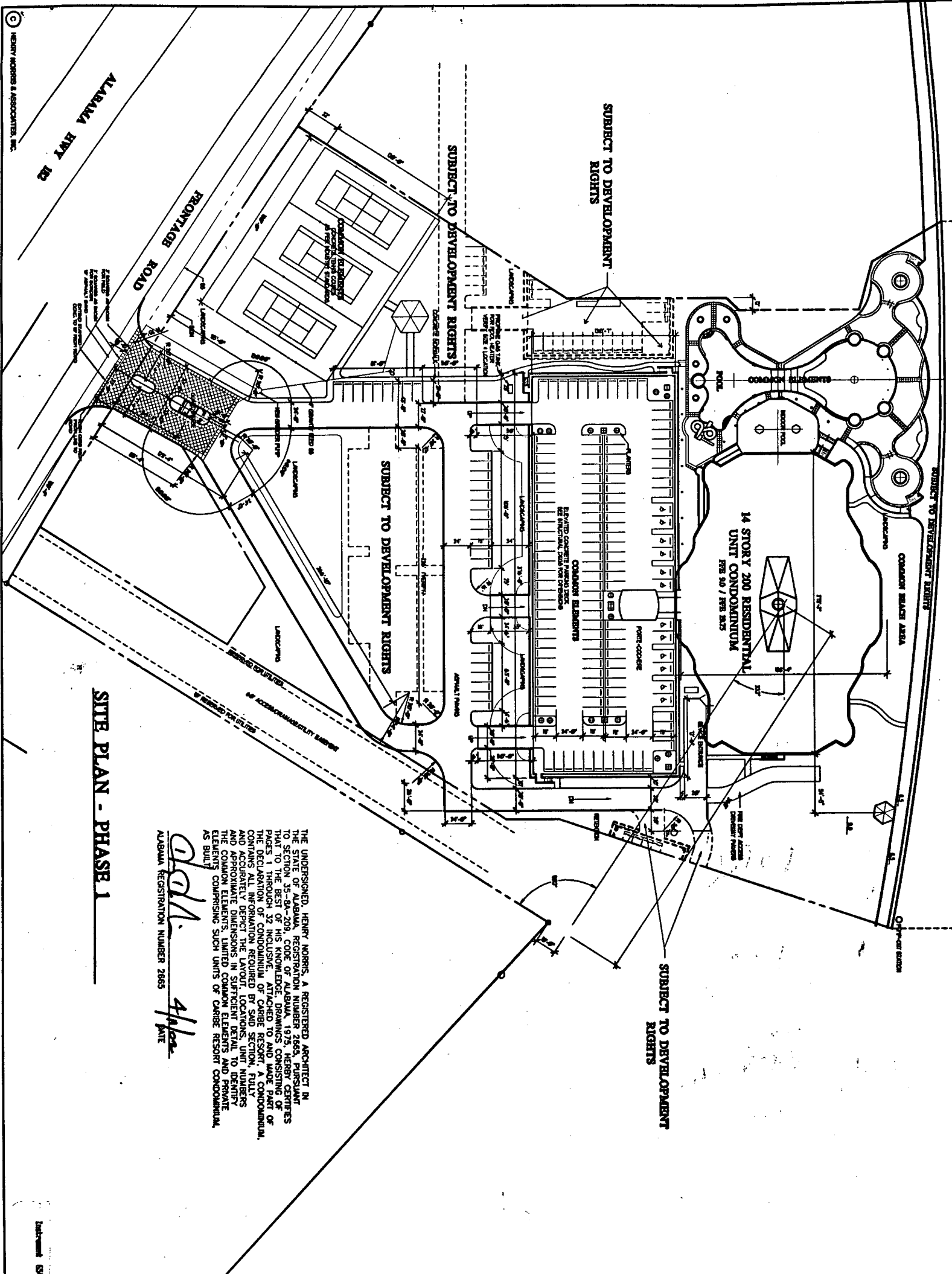

SITE PLAN - PHASE 1

THE UNDERSIGNED, HENRY MORRIS, A REGISTERED ARCHITECT IN THE STATE OF ALABAMA, BEING FULLY ADVISED OF HIS OBLIGATIONS AND THE BEST OF HIS KNOWLEDGE, DRAWINGS CONSISTING OF PAGES 1 THROUGH 32 INCLUSIVE, ATTACHED TO AND MADE PART OF THE DECLARATION OF CONDOMINIUM OF CARIBE RESORT, A CONDOMINIUM, CONTAINS ALL INFORMATION REQUIRED BY SAID SECTION, FULLY AND ACCURATELY DEPICT THE LAYOUT, LOCATIONS, UNIT NUMBERS AND APPROXIMATE DIMENSIONS IN SUFFICIENT DETAIL TO IDENTIFY THE COMMON ELEMENTS, LIMITED COMMON ELEMENTS AND PRIVATE ELEMENTS COMPRISING SUCH UNITS OF CARIBE RESORT CONDOMINIUM, AS BUILT.

Henry Morris
 ALABAMA REGISTRATION NUMBER 2865
 DATE



	HENRY MORRIS & ASSOC., INC. ARCHITECTURE & ENVIRONMENTAL DESIGN	30 N. PALM BLVD. PENSACOLA, FLORIDA 32501 (850) 432-6011 FAX 432-6011 henry@hnmorris.com
	CARIBE RESORT ORANGE BEACH, ALABAMA	
JOB NO. 000907 DATE: 08/08/04 DATE: 04/08/05 ENGINEER	SHEET 1 OF 32	SHEET OF 32

HENRY MORRIS & ASSOCIATES, INC.